

ER COLLET SETS/COOLANT COLLETS

ER COLLET SETS INCH & METRIC SIZES



AccuCollets™ Precision Collets DIN 6499-form B (ER) set new standards of accuracy. Precision Collets concentricity is 15 microns or 0.0005" TIR or better.

- ER, TG, DA, AF, Coolant & Tap Collets Also Available
- Inch & Metric Sizes
- Straight Shank and V-flange Collet Holders Available.



Fractional Collets Manufactured Specifically To US Market Requirements! Use "On Size" Collet For Best Results!

E **Accu-Collets**

Type	Style	Description	No. Of Collets	Part Number	Set Price
ER-8	Metric	1mm to 5mm x .5mm	9	08-SET9	\$99.00
	Inch	1/16"-3/16" x 1/64	9	08-SET9-INCH	\$99.00
ER-11	Metric	1mm to 7mm x .5mm	13	11-SET13	\$143.00
	Inch	1/16"-1/4" x 1/32	7	11-SET7-INCH	\$77.00
	Inch	1/16" - 1/4" x 1/64	13	11-SET13-INCH	\$143.00
ER-16	Metric	1mm to 10mm x 1mm	10	16-SET10	\$110.00
	Inch	1/16" - 3/8" x 1/32"	11	16-SET11-INCH	\$121.00
ER-20	Metric	1mm to 13mm x 1mm	12	20-SET12	\$144.00
	Inch	1/16" - 1/2" x 1/32"	15	20-SET15-INCH	\$180.00
ER-25	Metric	2mm to 16mm x 1mm	15	25-SET15	\$180.00
	Inch	1/16" - 5/8" x 1/32"	18	25-SET18-INCH	\$216.00
ER-32	Metric	3mm to 20mm x 1mm	18	32-SET18	\$216.00
	Inch	1/8"-3/4" x 1/32"	21	32-SET21-INCH	\$252.00
ER-40	Metric	4mm to 26mm x 1mm	23	40-SET23	\$345.00
	Inch	1/8"-1" x 1/64"	15	40-SET15-INCH	\$225.00
	Inch	1/8" - 1" x 1/32"	29	40-SET29-INCH	\$435.00

ER INCH & METRIC COOLANT COLLETS

FEATURES:

- Unique patented design is solid steel construction ensuring longer life.
- No discs, plugs or other hardware needed.
- No rubber or silicone to wear out.
- Maximum pressure of 1000 psi.
- Drill insertion does not need to be longer than the collet length.
- Lyndex coolant style ER collets feature a unique patented design which staggers the slots to prevent coolant from reaching the face of the collet.

Note: ER coolant collets are designed for use with cylindrical shank tools (no flats). Use of coolant collets with tools that are not cylindrical will result in coolant leakage.



Accu-Collets



E

B

			ER 11 Coolant Collets		ER 16 Coolant Collets	
			Accu-Collets	Lyndex	Accu-Collets	Lyndex
Frac	MM	Dec.	\$22.05 ea	\$47.00 ea	\$23.28 ea	\$47.00 ea
1/8	3.0	0.1180	11-0118-3.0C	11-0118-3.0CL	16-0118-3.0C	16-0118-3.0CL
	-	0.1250	11-0125-1/8C	11-0125-1/8CL	16-0125-1/8C	-
	3.5	0.1380	11-0138-3.5C	11-0138-3.5CL	16-0138-3.5C	16-0138-3.5CL
9/64	-	0.1400	11-0140-9/64C	11-0140-9/64CL	16-0140-9/64C	-
	5/32	-	11-0156-5/32C	11-0156-5/32CL	16-0156-5/32C	-
	-	4.0	11-0157-4.0C	11-0157-4.0CL	16-0157-4.0C	16-0157-4.0CL
11/64	-	0.1710	11-0171-11/64C	11-0171-11/64CL	16-0171-11/64C	-
	-	4.5	11-0177-4.5C	11-0177-4.5CL	16-0177-4.5C	16-0177-4.5CL
	3/16	-	11-0187-3/16C	11-0187-3/16CL	16-0187-3/16C	16-0187-3/16CL
13/64	-	0.1960	11-0196-5.0C	11-0196-5.0CL	16-0196-5.0C	16-0196-5.0CL
	-	0.2030	11-0203-13/64C	11-0203-13/64CL	16-0203-13/64C	16-0203-13/64CL
	-	5.5	11-0217-5.5C	11-0217-5.5CL	16-0217-5.5C	16-0217-5.5CL
15/64	-	0.2180	11-0218-7/32C	11-0218-7/32CL	16-0218-7/32C	16-0218-7/32CL
	-	0.2340	11-0234-15/64C	11-0234-15/64CL	16-0234-15/64C	16-0234-15/64CL
	-	6.0	11-0236-6.0C	11-0236-6.0CL	16-0236-6.0C	16-0236-6.0CL
1/4	-	0.2500	11-0250-1/4C	11-0250-1/4CL	16-0250-1/4C	16-0250-1/4CL
	-	6.5	11-0256-6.5C	11-0256-6.5CL	16-0256-6.5C	16-0256-6.5CL
	17/64	-	11-0265-17/64C	11-0265-17/64CL	16-0265-17/64C	16-0265-17/64CL
9/32	-	0.2750	11-0275-7.0C	11-0275-7.0CL	16-0275-7.0C	16-0275-7.0CL
	-	0.2812	-	-	16-0281-9/32C	16-0281-9/32CL
	-	0.2953	-	-	16-0295-7.5C	16-0295-7.5CL
19/64	-	0.2969	-	-	16-0296-19/64C	16-0296-19/64CL
	5/16	-	0.3125	-	16-0312-5/16C	16-0312-5/16CL
	-	8.0	0.3150	-	16-0315-8.0C	16-0315-8.0CL
21/64	-	0.3281	-	-	16-0328-21/64C	16-0328-21/64CL
	-	8.5	0.3346	-	16-0334-8.5C	16-0334-8.5CL
	11/32	-	0.3438	-	16-0343-11/32C	16-0343-11/32CL
23/64	-	0.3543	-	-	16-0354-9.0C	16-0354-9.0CL
	-	0.3594	-	-	16-0359-23/64C	16-0359-23/64CL
	-	9.5	0.3740	-	16-0374-9.5C	16-0374-9.5CL
3/8	-	0.3750	-	-	16-0375-3/8C	16-0375-3/8CL
	25/64	-	0.3906	-	16-0390-25/64C	16-0390-25/64CL
	-	10.0	0.3937	-	16-0393-10.0C	16-0393-10.0CL

Nominal I.D. (OD)		L		Max. Runout	
mm	Inch	mm	Inch	mm	Inch
4 - 6	.1575"-.2362"	16	.6299"	0.010	.0004"
6 - 10	.2362"-.3937"	25	.9842"		
10 - 18	.3937"-.7086"	40	1.5748"	0.015	.0006"
18 - 26	.7086"-1.0236"	50	1.9685"		

Call Us Today For All Of Your Machine Tool Needs!

ER COOLANT COLLETS

ER INCH & METRIC COOLANT COLLETS

FEATURES:

- Unique patented design is solid steel construction ensuring longer life.
- No discs, plugs or other hardware needed.
- No rubber or silicone to wear out.
- Maximum pressure of 1000 psi.
- Drill insertion does not need to be longer than the collet length.
- Lyndex coolant style ER collets feature a unique patented design which staggers the slots to prevent coolant from reaching the face of the collet.



Accu-Collets

E

LYNDEX

B

Note: ER coolant collets are designed for use with cylindrical shank tools (no flats). Use of coolant collets with tools that are not cylindrical will result in coolant leakage.

			ER 20 Coolant Collets		ER 25 Coolant Collets		ER 32 Coolant Collets		ER 40 Coolant Collets	
			Accu-Collets	Lyndex	Accu-Collets	Lyndex	Accu-Collets	Lyndex	Accu-Collets	Lyndex
Frac	MM	Dec.	\$24.01 ea	\$55.00 ea	\$25.03 ea	\$58.00 ea	\$25.76 ea	\$59.50 ea	\$28.21	\$67.50 ea
-	3.0	0.1180	20-0118-3.0C	20-0118-3.0CL	25-0118-3.0C	25-0118-3.0CL	32-0118-3.0C	32-0118-3.0CL	-	-
1/8	-	0.1250	20-0125-1/8C	-	25-0125-1/8C	-	32-0125-1/8C	-	-	-
5/32	-	0.1560	20-0156-5/32C	-	25-0156-5/32C	-	32-0156-5/32C	-	40-0156-5/32C	40-0156-5/32CL
-	4.0	0.1570	20-0157-4.0C	20-0157-4.0CL	25-0157-4.0C	25-0157-4.0CL	32-0157-4.0C	32-0157-4.0CL	40-0157-4.0C	40-0157-4.0CL
3/16	-	0.1870	20-0187-3/16C	20-0187-3/16CL	25-0187-3/16C	25-0187-3/16CL	32-0187-3/16C	32-0187-3/16CL	40-0187-3/16C	40-0187-3/16CL
-	5.0	0.1960	20-0196-5.0C	20-0196-5.0CL	25-0196-5.0C	25-0196-5.0CL	32-0196-5.0C	32-0196-5.0CL	40-0196-5.0C	40-0196-5.0CL
7/32	-	0.2180	20-0218-7/32C	20-0218-7/32CL	25-0218-7/32C	25-0218-7/32CL	32-0218-7/32C	32-0218-7/32CL	40-0218-7/32C	40-0218-7/32CL
-	6.0	0.2360	20-0236-6.0C	20-0236-6.0CL	25-0236-6.0C	25-0236-6.0CL	32-0236-6.0C	32-0236-6.0CL	40-0236-6.0C	40-0236-6.0CL
1/4	-	0.2500	20-0250-1/4C	20-0250-1/4CL	25-0250-1/4C	25-0250-1/4CL	32-0250-1/4C	32-0250-1/4CL	40-0250-1/4C	40-0250-1/4CL
-	7.0	0.2750	20-0275-7.0C	20-0275-7.0CL	25-0275-7.0C	25-0275-7.0CL	32-0275-7.0C	32-0275-7.0CL	40-0275-7.0C	40-0275-7.0CL
9/32	-	0.2810	20-0281-9/32C	20-0281-9/32CL	25-0281-9/32C	25-0281-9/32CL	32-0281-9/32C	32-0281-9/32CL	40-0281-9/32C	40-0281-9/32CL
5/16	-	0.3120	20-0312-5/16C	20-0312-5/16CL	25-0312-5/16C	25-0312-5/16CL	32-0312-5/16C	32-0312-5/16CL	40-0312-5/16C	40-0312-5/16CL
-	8.0	0.3150	20-0315-8.0C	20-0315-8.0CL	25-0315-8.0C	25-0315-8.0CL	32-0315-8.0C	32-0315-8.0CL	40-0315-8.0C	40-0315-8.0CL
11/32	-	0.3430	20-0343-11/32C	20-0343-11/32CL	25-0343-11/32C	25-0343-11/32CL	32-0343-11/32C	32-0343-11/32CL	40-0343-11/32C	40-0343-11/32CL
-	9.0	0.3540	20-0354-9.0C	20-0354-9.0CL	25-0354-9.0C	25-0354-9.0CL	32-0354-9.0C	32-0354-9.0CL	40-0354-9.0C	40-0354-9.0CL
3/8	-	0.3750	20-0375-3/8C	20-0375-3/8CL	25-0375-3/8C	25-0375-3/8CL	32-0375-3/8C	32-0375-3/8CL	40-0375-3/8C	40-0375-3/8CL
-	10.0	0.3930	20-0393-10.0C	20-0393-10.0CL	25-0393-10.0C	25-0393-10.0CL	32-0393-10.0C	32-0393-10.0CL	40-0393-10.0C	40-0393-10.0CL
13/32	-	0.4060	20-0406-13/32C	20-0406-13/32CL	25-0406-13/32C	25-0406-13/32CL	32-0406-13/32C	32-0406-13/32CL	40-0406-13/32C	40-0406-13/32CL
-	11.0	0.4330	20-0433-11.0C	20-0433-11.0CL	25-0433-11.0C	25-0433-11.0CL	32-0433-11.0C	32-0433-11.0CL	40-0433-11.0C	40-0433-11.0CL
7/16	-	0.4370	20-0437-7/16C	20-0437-7/16CL	25-0437-7/16C	25-0437-7/16CL	32-0437-7/16C	32-0437-7/16CL	40-0437-7/16C	40-0437-7/16CL
15/32	-	0.4680	20-0468-15/32C	20-0468-15/32CL	25-0468-15/32C	25-0468-15/32CL	32-0468-15/32C	32-0468-15/32CL	40-0468-15/32C	40-0468-15/32CL
-	12.0	0.4720	20-0472-12.0C	20-0472-12.0CL	25-0472-12.0C	25-0472-12.0CL	32-0472-12.0C	32-0472-12.0CL	40-0472-12.0C	40-0472-12.0CL
1/2	-	0.5000	20-0500-1/2C	20-0500-1/2CL	25-0500-1/2C	25-0500-1/2CL	32-0500-1/2C	32-0500-1/2CL	40-0500-1/2C	40-0500-1/2CL
-	13.0	0.5110	20-0511-13.0C	20-0511-13.0CL	25-0511-13.0C	25-0511-13.0CL	32-0511-13.0C	32-0511-13.0CL	40-0511-13.0C	40-0511-13.0CL
17/32	-	0.5310	-	-	25-0531-17/32C	25-0531-17/32CL	32-0531-17/32C	32-0531-17/32CL	40-0531-17/32C	40-0531-17/32CL
-	14.0	0.5510	-	-	25-0551-14.0C	25-0551-14.0CL	32-0551-14.0C	32-0551-14.0CL	40-0551-14.0C	40-0551-14.0CL
9/16	-	0.5620	-	-	25-0562-9/16C	25-0562-9/16CL	32-0562-9/16C	32-0562-9/16CL	40-0562-9/16C	40-0562-9/16CL
-	15.0	0.5900	-	-	25-0590-15.0C	25-0590-15.0CL	32-0590-15.0C	32-0590-15.0CL	40-0590-15.0C	40-0590-15.0CL
19/32	-	0.5930	-	-	25-0593-19/32C	25-0593-19/32CL	32-0593-19/32C	32-0593-19/32CL	40-0593-19/32C	40-0593-19/32CL
5/8	-	0.6250	-	-	25-0625-5/8C	25-0625-5/8CL	32-0625-5/8C	32-0625-5/8CL	40-0625-5/8C	40-0625-5/8CL
-	16.0	0.6300	-	-	25-0630-16.0C	25-0630-16.0CL	32-0630-16.0C	32-0630-16.0CL	40-0630-16.0C	40-0630-16.0CL
21/32	-	0.6560	-	-	-	-	32-0656-21/32C	32-0656-21/32CL	40-0656-21/32C	40-0656-21/32CL
-	17.0	0.6690	-	-	-	-	32-0669-17.0C	32-0669-17.0CL	40-0669-17.0C	40-0669-17.0CL
11/16	-	0.6870	-	-	-	-	32-0687-11/16C	32-0687-11/16CL	40-0687-11/16C	40-0687-11/16CL
-	18.0	0.7080	-	-	-	-	32-0708-18.0C	32-0708-18.0CL	40-0708-18.0C	40-0708-18.0CL
23/32	-	0.7180	-	-	-	-	32-0718-23/32C	32-0718-23/32CL	40-0718-23/32C	40-0718-23/32CL
-	19.0	0.7480	-	-	-	-	32-0748-19.0C	32-0748-19.0CL	40-0748-19.0C	40-0748-19.0CL
3/4	-	0.7500	-	-	-	-	32-0750-3/4C	32-0750-3/4CL	40-0750-3/4C	40-0750-3/4CL
25/32	-	0.7810	-	-	-	-	32-0781-25/32C	32-0781-25/32CL	40-0781-25/32C	40-0781-25/32CL
-	20.0	0.7870	-	-	-	-	32-0787-20.0C	32-0787-20.0CL	40-0787-20.0C	40-0787-20.0CL
13/16	-	0.8120	-	-	-	-	-	-	40-0812-13/16C	40-0812-13/16CL
-	21.0	0.8260	-	-	-	-	-	-	40-0826-21.0C	40-0826-21.0CL
27/32	-	0.8430	-	-	-	-	-	-	40-0843-27/32C	40-0843-27/32CL
-	22.0	0.8660	-	-	-	-	-	-	40-0866-22.0C	40-0866-22.0CL
7/8	-	0.8750	-	-	-	-	-	-	40-0875-7/8C	40-0875-7/8CL
-	23.0	0.9050	-	-	-	-	-	-	40-0905-23.0C	40-0905-23.0CL
29/32	-	0.9060	-	-	-	-	-	-	40-0906-29/32C	40-0906-29/32CL
15/16	-	0.9370	-	-	-	-	-	-	40-0937-15/16C	40-0937-15/16CL
-	24.0	0.9440	-	-	-	-	-	-	40-0944-24.0C	40-0944-24.0CL
31/32	-	0.9680	-	-	-	-	-	-	40-0968-31/32C	40-0968-31/32CL
-	25.0	0.9840	-	-	-	-	-	-	40-0984-25.0C	40-0984-25.0CL
1	-	1.0000	-	-	-	-	-	-	40-1000-1-INCL	40-1000-1-INCL
-	26.0	1.0236	-	-	-	-	-	-	40-1024-26.0C	40-1024-26.0CL

Call Us Or Visit Our Website For Our Complete Selection!

ER TAPPING COLLETS

ER TAP COLLETS FOR RIGID TAPPING

These collets feature a unique design that incorporates an internal square drive with our popular ER series collets. The square drives match the tap square providing a tight fit for all rigid tapping applications. Utilizing ER tap collets and a standard ER collet chuck allows you to vary the gage length of your tapping application without the need for special tapholders.

Accu-Collets



E **B**



ANSI Standard			ER 11	ER 16 Tap Collets			ER 20 Tap Collets	
Tap Size	Shank Size	Square Size	AccuCollets	AccuCollets	Lyndex	AccuCollets	Lyndex	
#0 - 6	0.141	0.110	11-141-RA-AC	16-141-RA-AC	16-141-RA-LY	20-141-RA-AC	20-141-RA-LY	
#8	0.168	0.131	11-118-RA-AC	16-168-RA-AC	16-168-RA-LY	20-168-RA-AC	20-168-RA-LY	
#10	0.194	0.152	11-194-RA-AC	16-194-RA-AC	16-194-RA-LY	20-194-RA-AC	20-194-RA-LY	
#12	0.220	0.165	11-220-RA-AC	16-220-RA-AC	16-220-RA-LY	20-220-RA-AC	20-220-RA-LY	
1/4	0.255	0.191	11-225-RA-AC	16-225-RA-AC	16-225-RA-LY	20-225-RA-AC	20-225-RA-LY	
5/16	0.318	0.238	-	16-318-RA-AC	-	20-318-RA-AC	20-318-RA-LY	
3/8	0.381	0.286	-	-	-	20-381-RA-AC	20-381-RA-LY	
7/16	0.323	0.242	-	-	-	20-323-RA-AC	20-323-RA-LY	
1/2	0.367	0.275	-	-	-	20-367-RA-AC	20-367-RA-LY	
9/16	0.429	0.322	-	-	-	-	-	
5/8	0.480	0.360	-	-	-	-	-	
11/16	0.542	0.406	-	-	-	-	-	
3/4	0.590	0.442	-	-	-	-	-	
13/16	0.652	0.489	-	-	-	-	-	
7/8	0.697	0.523	-	-	-	-	-	
15/16	0.760	0.570	-	-	-	-	-	
1"	0.800	0.600	-	-	-	-	-	

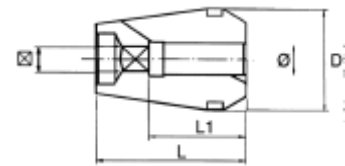

	ER-16	ER-20	ER-25
D	16.0mm	20.0mm	25.0mm
L	27.5mm	31.5mm	34.0mm

	ER-32	ER-40
D	32.0mm	40.0mm
L	40.0mm	46.0mm

ANSI Standard			ER 25 Tap Collets		ER 32 Tap Collets		ER 40 Tap Collets	
Tap Size	Shank Size	Square Size	AccuCollets	Lyndex	AccuCollets	Lyndex	AccuCollets	Lyndex
#0 - 6	0.141	0.110	25-141-RA-AC	25-141-RA-LY	32-141-RA-AC	32-141-RA-LY	40-141-RA-AC	40-141-RA-LY
#8	0.168	0.131	25-168-RA-AC	25-168-RA-LY	32-168-RA-AC	32-168-RA-LY	40-168-RA-AC	40-168-RA-LY
#10	0.194	0.152	25-194-RA-AC	25-194-RA-LY	32-194-RA-AC	32-194-RA-LY	40-194-RA-AC	40-194-RA-LY
#12	0.220	0.165	25-220-RA-AC	25-220-RA-LY	32-220-RA-AC	32-220-RA-LY	40-220-RA-AC	40-220-RA-LY
1/4	0.255	0.191	25-225-RA-AC	25-225-RA-LY	32-225-RA-AC	32-225-RA-LY	40-225-RA-AC	40-225-RA-LY
5/16	0.318	0.238	25-318-RA-AC	25-318-RA-LY	32-318-RA-AC	32-318-RA-LY	40-318-RA-AC	40-318-RA-LY
3/8	0.381	0.286	25-381-RA-AC	25-381-RA-LY	32-381-RA-AC	32-381-RA-LY	40-381-RA-AC	40-381-RA-LY
7/16	0.323	0.242	25-323-RA-AC	25-323-RA-LY	32-323-RA-AC	32-323-RA-LY	40-323-RA-AC	40-323-RA-LY
1/2	0.367	0.275	25-367-RA-AC	25-367-RA-LY	32-367-RA-AC	32-367-RA-LY	40-367-RA-AC	40-367-RA-LY
9/16	0.429	0.322	25-429-RA-AC	25-429-RA-LY	32-429-RA-AC	32-429-RA-LY	40-429-RA-AC	40-429-RA-LY
5/8	0.480	0.360	25-480-RA-AC	25-480-RA-LY	32-480-RA-AC	32-480-RA-LY	40-480-RA-AC	40-480-RA-LY
11/16	0.542	0.406	-	-	32-542-RA-AC	32-542-RA-LY	40-542-RA-AC	40-542-RA-LY
3/4	0.590	0.442	-	-	32-590-RA-AC	32-590-RA-LY	40-590-RA-AC	40-590-RA-LY
13/16	0.652	0.489	-	-	32-652-RA-AC	32-652-RA-LY	40-652-RA-AC	40-652-RA-LY
7/8	0.697	0.523	-	-	-	-	40-697-RA-AC	40-697-RA-LY
15/16	0.760	0.570	-	-	-	-	40-760-RA-AC	40-760-RA-LY
1"	0.800	0.600	-	-	-	-	40-800-RA-AC	40-800-RA-LY

ER TAP COOLANT COLLETS FOR RIGID TAPPING



Accu-Collets



E **B**

ANSI Standard			ER 16	ER 20 Tap Coolant Collets		ER 25 Tap Coolant Collets		ER 32 Tap Coolant Collets		ER 40 Tap Coolant Collets	
Tap Size	Shank Size	Square Size	Lyndex	AccuCollets	Lyndex	AccuCollets	Lyndex	AccuCollets	Lyndex	AccuCollets	Lyndex
#0-6	0.141	0.110	16-141-RAC-LY	-	20-141-RAC-LY	-	25-141-RAC-LY	32-141-RAC-AC	-	40-141-RAC-AC	-
#8	0.168	0.131	16-168-RAC-LY	-	20-168-RAC-LY	-	25-168-RAC-LY	32-168-RAC-AC	-	40-168-RAC-AC	-
#10	0.194	0.152	16-194-RAC-LY	-	20-194-RAC-LY	-	25-194-RAC-LY	32-194-RAC-AC	-	40-194-RAC-AC	-
#12	0.220	0.165	16-220-RAC-LY	-	20-220-RAC-LY	-	25-220-RAC-LY	32-220-RAC-AC	-	40-220-RAC-AC	-
1/4	0.255	0.191	16-225-RAC-LY	20-225-RAC-AC	20-225-RAC-LY	-	25-225-RAC-LY	32-225-RAC-AC	32-225-RAC-LY	40-225-RAC-AC	-
5/16	0.318	0.238	16-318-RAC-LY	20-318-RAC-AC	20-318-RAC-LY	25-318-RAC-AC	25-318-RAC-LY	32-318-RAC-AC	32-318-RAC-LY	40-318-RAC-AC	-
3/8	0.381	0.286	-	20-381-RAC-AC	20-381-RAC-LY	25-381-RAC-AC	25-381-RAC-LY	32-381-RAC-AC	32-381-RAC-LY	40-381-RAC-AC	40-381-RAC-LY
7/16	0.323	0.242	-	20-323-RAC-AC	20-323-RAC-LY	25-323-RAC-AC	25-323-RAC-LY	32-323-RAC-AC	32-323-RAC-LY	40-323-RAC-AC	40-323-RAC-LY
1/2	0.367	0.275	-	20-367-RAC-AC	20-367-RAC-LY	25-367-RAC-AC	25-367-RAC-LY	32-367-RAC-AC	32-367-RAC-LY	40-367-RAC-AC	40-367-RAC-LY
9/16	0.429	0.322	-	-	-	25-429-RAC-AC	25-429-RAC-LY	32-429-RAC-AC	32-429-RAC-LY	40-429-RAC-AC	40-429-RAC-LY
5/8	0.480	0.360	-	-	-	25-480-RAC-AC	25-480-RAC-LY	32-480-RAC-AC	32-480-RAC-LY	40-480-RAC-AC	40-480-RAC-LY
11/16	0.542	0.406	-	-	-	-	-	32-542-RAC-AC	32-542-RAC-LY	40-542-RAC-AC	40-542-RAC-LY
3/4	0.590	0.442	-	-	-	-	-	32-590-RAC-AC	32-590-RAC-LY	40-590-RAC-AC	40-590-RAC-LY
13/16	0.652	0.489	-	-	-	-	-	32-652-RAC-AC	32-652-RAC-LY	40-652-RAC-AC	40-652-RAC-LY
7/8	0.697	0.523	-	-	-	-	-	-	-	40-697-RAC-AC	40-697-RAC-LY
15/16	0.760	0.570	-	-	-	-	-	-	-	40-760-RAC-AC	40-760-RAC-LY
1"	0.800	0.600	-	-	-	-	-	-	-	40-800-RAC-AC	40-800-RAC-LY

Call Us Today For All Of Your Machine Tool Needs!