

# CAT-50 TOOL HOLDERS

## END MILL HOLDERS

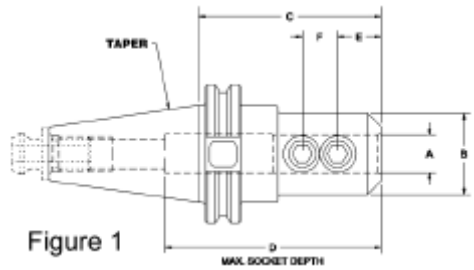

Figure 1

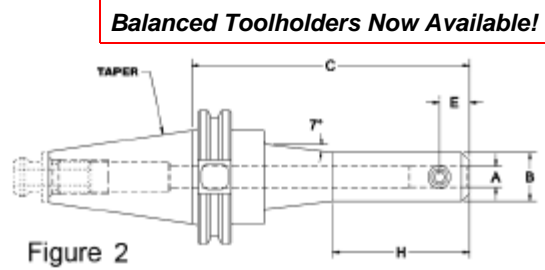

Figure 2

Balanced Toolholders Now Available!



### 1/8" CAT-50 Endmill Holders-1/8" (.1250) Diameter

C Proj.	B Outside (Dia.)	D	Fig. No.	E	H Ext. Proj.	End Mill Type	Tight. Torque (ft.lbs.)	Vendor	Part Number	Price Each	Set Screw Part Number	Set Screw Size	MAX RPM Balanced Up To	Code
2.500	0.690	3.00	2	0.19	-	S / D	3	Parlec	C50-01EM250-P	\$149.80	SS-029-014-P	M10 - 32	-	B

### 3/16" CAT-50 Endmill Holders-3/16" (.1875) Diameter

C Proj.	B Outside (Dia.)	D	Fig. No.	E	H Ext. Proj.	End Mill Type	Tight. Torque (ft.lbs.)	Vendor	Part Number	Price Each	Set Screw Part Number	Set Screw Size	MAX RPM Balanced Up To	Code
2.500	0.690	-	1	0.56	-	-	-	Collis	C50-18EM250-C	\$85.68	SS-64869-C	-	-	C
	0.680	-	-	0.56	-	S / D	-	Domestic	C50-18EM250-A	\$113.05	SS-1/4-28W-A	-	-	B
	0.690	-	2	0.44	-	S / D	4	Parlec	C50-18EM250-P	\$93.10	SS-029-014-P	-	-	B
	0.690	-	2	0.44	-	-	-	USST	C50-18EM250-U	\$70.00	SS-029-015-U	-	-	D
4.500	0.680	-	-	0.56	-	S / D	-	Domestic	C50-18EM450-A	\$144.50	SS-1/4-28W-A	-	-	B
6.500	0.680	-	-	0.56	-	S / D	-	Domestic	C50-18EM650-A	\$183.60	SS-1/4-28W-A	-	-	B

### 1/4" CAT-50 Endmill Holders-1/4" (.2500) Diameter

C Proj.	B Outside (Dia.)	D	Fig. No.	E	H Ext. Proj.	End Mill Type	Tight. Torque (ft.lbs.)	Vendor	Part Number	Price Each	Set Screw Part Number	Set Screw Size	MAX RPM Balanced Up To	Code
1.375	2.750	-	-	-	-	-	-	Collis	C50-25EM138-C	\$85.68	-	-	-	C
								Collis	C50-25EM138-CB	\$96.88	-	-	15,000G2.5	C
1.380	0.780	4.00	1	0.75	-	-	5	SpinTru	C50-25EM138-KB	\$97.24	-	-	15,000G2.5	D
	0.790	-	-	-	-	-	-	Sowa	C50-25EM138-GB	\$97.24	-	1/4-28	15,000	C
2.500	0.780	4.00	1	0.75	-	-	5	SpinTru	C50-25EM250-KB	\$97.24	-	-	15,000	D
	0.690	-	1	0.56	-	-	-	Collis	C50-25EM250-C	\$85.68	SS-64840-C	-	-	C
	0.875	-	-	0.56	-	S / D	-	Domestic	C50-25EM250-A	\$103.70	SS-1/4-28W-A	-	-	B
	0.790	-	-	-	-	-	-	Sowa	C50-25EM250-GB	\$97.24	-	1/4-28	15,000	C
	0.880	-	2	0.44	-	-	-	USST	C50-25EM250-U	\$70.00	SS-029-018-U	-	-	D
4.000	0.790	-	-	-	-	-	-	Sowa	C50-25EM400-GB	\$97.24	-	1/4-28	15,000	C
	-	-	-	-	-	-	-	SpinTru	C50-25EM400-KB	\$97.24	-	-	15,000G2.5	D
4.500	0.875	-	-	0.56	-	S / D	-	Domestic	C50-25EM450-A	\$107.80	SS-1/4-28W-A	-	-	B
6.000	0.790	-	-	-	-	-	-	Sowa	C50-25EM600-GB	\$105.74	-	1/4-28	15,000	C
	-	-	-	-	-	-	-	SpinTru	C50-25EM600-KB	\$105.74	-	-	15,000G2.5	D
6.500	0.875	-	-	0.56	-	S / D	-	Domestic	C50-25EM650-A	\$121.10	SS-1/4-28W-A	-	-	B
8.000	0.790	-	-	-	-	-	-	Sowa	C50-25EM800-GB	\$123.59	-	1/4-28	15,000	C
	-	-	-	-	-	-	-	SpinTru	C50-25EM800-KB	\$123.59	-	-	15,000G2.5	D

### 5/16" CAT-50 Endmill Holders-5/16" (.3125) Diameter

C Proj.	B Outside (Dia.)	D	Fig. No.	E	H Ext. Proj.	End Mill Type	Tight. Torque (ft.lbs.)	Vendor	Part Number	Price Each	Set Screw Part Number	Set Screw Size	MAX RPM Balanced Up To	Code
2.500	1.000	4.00	1	0.56	-	-	10	SpinTru	C50-31EM250-KB	\$93.76	-	-	15,000G2.5	D
	1.000	-	1	0.75	-	-	-	Collis	C50-31EM250-C	\$85.68	SS-64840-C	-	-	C
	1.000	-	-	0.56	-	S / D	-	Domestic	C50-31EM250-A	\$113.05	SS-1/4-28W-A	-	-	B
	1.000	3.00	2	0.44	-	S / D	9	Parlec	C50-31EM250-P	\$105.00	SS-029-018-P	-	-	B
	0.870	-	-	-	-	-	-	Sowa	C50-31EM250-GB	\$93.76	-	5/16-24	15,000	C
4.000	1.000	-	2	0.60	-	-	-	USST	C50-31EM250-U	\$70.00	SS-029-019-U	-	-	D
	0.870	-	-	-	-	-	-	SpinTru	C50-31EM400-KB	\$93.76	-	-	15,000G2.5	D
4.500	0.100	-	-	0.56	-	S / D	-	Domestic	C50-31EM450-A	\$130.90	SS-1/4-28W-A	-	-	B
	-	-	-	-	-	-	-	SpinTru	C50-31EM600-KB	\$102.26	-	-	15,000G2.5	D
6.000	0.870	-	-	-	-	-	-	Sowa	C50-31EM600-GB	\$102.26	-	5/16-24	15,000	C
6.500	1.000	-	-	0.56	-	S / D	-	Domestic	C50-31EM650-A	\$121.10	SS-1/4-28W-A	-	-	B

Call Us Today For All Of Your Machine Tool Needs!

# CAT-50 TOOL HOLDERS

## END MILL HOLDERS

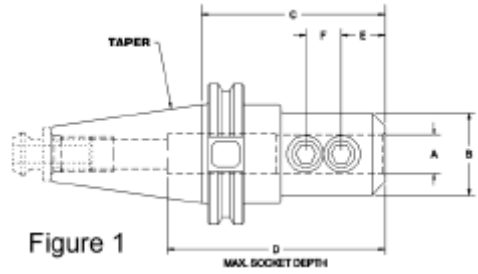

Figure 1

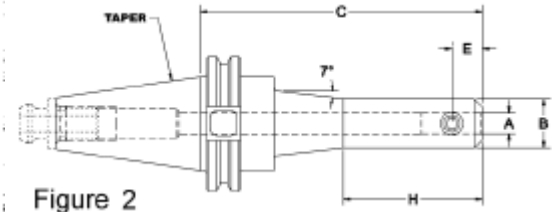

Figure 2

Balanced Toolholders Now Available!

SPIN  
TRU

PARLEC

USST

SOWA

COLLIS  
TOOL CORPORATION  
DOMESTIC  
PRECISION QUALITY

### 3/8" CAT-50 Endmill Holders-3/8" (.3750) Diameter

C Proj.	B Outside (Dia.)	D	Fig. No.	E	H Ext. Proj.	End Mill Type	Tight. Torque (ft.lbs.)	Vendor	Part Number	Price Each	Set Screw Part Number	Set Screw Size	MAX RPM Balanced Up To	Code
1.375	2.750	-	-	-	-	-	-	Collis	C50-37EM138-C	\$85.68	-	-	-	C
	-	-	-	-	-	-	-	Collis	C50-37EM138-CB	\$96.88	-	-	15,000G2.5	C
1.380	1.000	5.08	1	0.75	-	-	15	SpinTru	C50-37EM138-KB	\$88.74	-	-	15,000G2.5	D
	1.000	-	-	-	-	-	-	Sowa	C50-37EM138-GB	\$88.74	-	3/8-24	15000	C
2.500	1.000	5.08	1	0.75	-	-	15	SpinTru	C50-37EM250-KB	\$88.74	-	-	15000	D
	1.000	-	1	0.75	-	-	-	Collis	C50-37EM250-C	\$85.68	SS-64841-C	-	-	C
	1.000	-	-	0.75	-	-	-	Domestic	C50-37EM250-A	\$81.90	SS-3/8-24W-A	-	-	B
	1.000	3.00	2	0.75	-	S/D	12	Parlec	C50-37EM250-P	\$79.80	SS-029-902-P	-	-	B
	1.000	-	-	-	-	-	-	Sowa	C50-37EM250-GB	\$88.74	-	3/8-24	15000	C
	1.000	-	2	0.75	-	-	-	USST	C50-37EM250-U	\$70.00	SS-029-902-U	-	-	D
2.820	1.375	-	1	0.79	-	-	-	Collis	C50-37EM282-C	\$140.83	SS-64841-C	3/8" - 24	-	B
4.000	1.000	-	-	-	-	-	-	Sowa	C50-37EM400-GB	\$97.24	-	3/8-24	15000	C
	-	-	-	-	-	-	-	SpinTru	C50-37EM400-KB	\$97.24	-	-	15,000G2.5	D
4.500	1.000	-	-	0.75	-	S/D	-	Domestic	C50-37EM450-A	\$93.10	SS-3/8-24W-A	-	-	B
	1.000	3.00	2	0.75	-	S/D	12	Parlec	C50-37EM450-P	\$88.90	SS-029-902-P	-	-	B
	1.000	-	1	0.75	-	-	-	Collis	C50-37EM450-C	\$96.88	SS-64841-C	3/8" - 24	-	C
4.690	1.375	-	1	0.79	-	-	-	Collis	C50-37EM469-C	\$156.51	SS-64841-C	3/8" - 24	-	B
6.000	1.000	-	-	-	-	-	-	Sowa	C50-37EM600-GB	\$105.74	-	3/8-24	15000	C
	-	-	-	-	-	-	-	SpinTru	C50-37EM600-KB	\$105.74	-	-	15,000G2.5	D
6.500	1.000	-	-	0.75	-	S/D	-	Domestic	C50-37EM650-A	\$109.90	SS-3/8-24W-A	-	-	B
	1.000	-	1	0.75	-	-	-	Collis	C50-37EM650-C	\$96.88	SS-64841-C	3/8" - 24	-	C
	1.000	3.00	3	0.75	3.00	S/D	12	Parlec	C50-37EM650-P	\$102.90	SS-029-902-P	3/8" - 24	-	B
8.000	1.000	-	-	-	-	-	-	Sowa	C50-37EM800-GB	\$123.59	-	3/8-24	15000	C
	1.000	3.00	3	0.75	3.00	S/D	12	Parlec	C50-37EM800-P	\$179.90	SS-029-902-P	3/8" - 24	-	B
	-	-	-	-	-	-	-	SpinTru	C50-37EM800-KB	\$123.59	-	-	15,000G2.5	D
9.000	0.750	-	1	1.27	-	-	-	Collis	C50-37EM900-C	\$260.89	-	-	-	C
12.000	0.750	-	1	1.48	-	-	-	Collis	C50-37EM1200-C	\$260.89	-	-	-	C

### 7/16" CAT-50 Endmill Holders-7/16" (.4375) Diameter

C Proj.	B Outside (Dia.)	D	Fig. No.	E	H Ext. Proj.	End Mill Type	Tight. Torque (ft.lbs.)	Vendor	Part Number	Price Each	Set Screw Part Number	Set Screw Size	MAX RPM Balanced Up To	Code
2.500	1.250	5.00	1	0.75	-	-	21	SpinTru	C50-43EM250-KB	\$85.26	-	-	15,000G2.5	D
	1.250	-	-	0.75	-	S/D	-	Domestic	C50-43EM250-A	\$113.05	SS-3/8-24W-A	-	-	B
	1.380	-	-	-	-	-	-	Sowa	C50-43EM250-GB	\$85.26	-	7/16-20	15000	C
2.620	1.250	3.00	2	0.88	-	S	14	Parlec	C50-43EM262-P	\$91.00	SS-029-902-P	-	-	B
	1.250	-	2	0.88	-	-	-	USST	C50-43EM262-U	\$70.00	SS-029-903-U	-	-	D
4.000	-	-	-	-	-	-	-	SpinTru	C50-43EM400-KB	\$93.76	-	-	15,000G2.5	D
	1.380	-	-	-	-	-	-	Sowa	C50-43EM400-GB	\$93.76	-	7/16-20	15,000	C
4.500	1.250	-	-	0.75	-	S/D	-	Domestic	C50-43EM450-A	\$130.90	SS-3/8-24W-A	-	-	B
6.000	-	-	-	-	-	-	-	SpinTru	C50-43EM600-KB	\$102.26	-	-	15,000G2.5	D
	1.380	-	-	-	-	-	-	Sowa	C50-43EM600-GB	\$102.26	-	7/16-20	15,000	C
6.500	1.250	-	-	0.75	-	S/D	-	Domestic	C50-43EM650-A	\$147.05	SS-3/8-24W-A	-	-	B
8.000	-	-	-	-	-	-	-	SpinTru	C50-43EM800-KB	\$120.11	-	-	15,000G2.5	D
	1.380	-	-	-	-	-	-	Sowa	C50-43EM800-GB	\$120.11	-	7/16-20	15,000	C

Call Us Or Visit Our Website For Our Complete Selection!

# CAT-50 TOOL HOLDERS

## END MILL HOLDERS

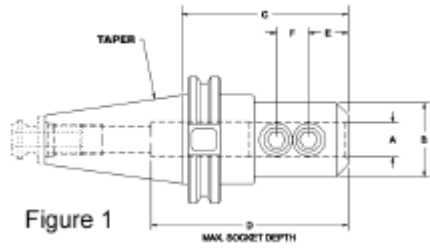

Figure 1

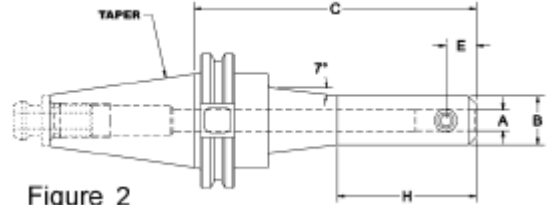

Figure 2



### 1/2" CAT-50 Endmill Holders-1/2" (.5000) Diameter

C Proj.	B Outside (Dia.)	D	Fig. No.	E	H Ext. Proj.	End Mill Type	Tight. Torque (ft.lbs.)	Vendor	Part Number	Price Each	Set Screw Part Number	Set Screw Size	MAX RPM Balanced Up To	Code
1.375	2.750	-	-	-	-	-	-	Collis	C50-50EM138-C	\$85.68	-	-	-	C
								Collis	C50-50EM138-CB	\$96.88	-	-	15,000G2.5	C
1.750	1.380	-	-	-	-	-	-	Sowa	C50-50EM175-GB	\$88.74	-	7/16-20	15,000	C
								SpinTru	C50-50EM175-KB	\$88.74	-	-	15,000G2.5	D
2.620	1.380	-	1	0.88	-	-	-	Collis	C50-50EM262-C	\$85.68	SS-64842-C	-	-	C
								Domestic	C50-50EM262-A	\$81.90	SS-7/16-20W-A	-	-	B
								Parlec	C50-50EM262-P	\$79.80	SS-029-917-P	-	-	B
								USST	C50-50EM262-U	\$70.00	SS-029-917-U	-	-	D
2.630	1.380	-	-	-	-	-	-	Sowa	C50-50EM263-GB	\$88.74	-	7/16-20	15,000	C
								SpinTru	C50-50EM263-KB	\$88.74	-	-	15,000G2.5	D
2.730	1.625	-	1	0.94	-	-	-	Collis	C50-50EM273-C	\$140.83	SS-64841-C	3/8" - 24	-	B
4.000	1.380	-	-	-	-	-	-	Sowa	C50-50EM400-GB	\$97.24	-	7/16-20	15,000	C
								SpinTru	C50-50EM400-KB	\$97.24	-	-	15,000G2.5	D
4.520	1.380	-	1	0.88	-	-	-	Collis	C50-50EM452-C	\$96.88	SS-64842-C	7/16" - 20	-	C
								Domestic	C50-50EM462-A	\$93.10	SS-7/16-20W-A	-	-	B
4.620	1.250	3.00	2	0.88	-	S/D	17	Parlec	C50-50EM462-P	\$88.90	SS-029-917-P	-	-	B
								Parlec	C50-50EM462-P	\$88.90	SS-029-917-P	-	-	B
6.000	1.380	-	-	-	-	-	-	Sowa	C50-50EM600-GB	\$105.74	-	7/16-20	15,000	C
								SpinTru	C50-50EM600-KB	\$105.74	-	-	15,000G2.5	D
6.620	1.250	-	-	0.88	-	S/D	-	Domestic	C50-50EM662-A	\$109.90	SS-7/16-20W-A	-	-	B
								Collis	C50-50EM662-C	\$100.59	SS-64842-C	7/16" - 20	-	C
								Parlec	C50-50EM662-P	\$98.00	SS-029-917-P	7/8" - 20	-	B
8.000	1.380	3.00	3	0.88	3.13	S/D	17	Sowa	C50-50EM800-GB	\$123.59	-	7/16-20	15,000	C
								Parlec	C50-50EM800-P	\$179.90	SS-029-917-P	7/8" - 20	-	B
								SpinTru	C50-50EM800-KB	\$123.59	-	-	15,000G2.5	D
9.000	0.880	-	1	1.40	-	-	-	Collis	C50-50EM900-C	\$260.89	-	-	-	C
12.000	0.880	-	1	1.61	-	-	-	Collis	C50-50EM1200-C	\$260.89	-	-	-	C

### 9/16" CAT-50 Endmill Holders-9/16" (.5625) Diameter

C Proj.	B Outside (Dia.)	D	Fig. No.	E	H Ext. Proj.	End Mill Type	Tight. Torque (ft.lbs.)	Vendor	Part Number	Price Each	Set Screw Part Number	Set Screw Size	MAX RPM Balanced Up To	Code
2.620	1.500	3.00	2	0.88	-	S	19	Parlec	C50-56EM262-P	\$109.20	SS-029-917-P	-	-	B
								USST	C50-56EM262-U	\$70.00	SS-029-917-U	-	-	D

### 5/8" CAT-50 Endmill Holders-5/8" (.6250) Diameter

C Proj.	B Outside (Dia.)	D	Fig. No.	E	H Ext. Proj.	End Mill Type	Tight. Torque (ft.lbs.)	Vendor	Part Number	Price Each	Set Screw Part Number	Set Screw Size	MAX RPM Balanced Up To	Code
1.375	2.750	-	-	-	-	-	-	Collis	C50-62EM138-C	\$85.68	-	-	-	C
								Collis	C50-62EM138-CB	\$96.88	-	-	15,000G2.5	C
1.750	1.650	-	-	-	-	-	-	Sowa	C50-62EM175-GB	\$88.74	-	9/16-18	15,000	C
								SpinTru	C50-62EM175-KB	\$88.74	-	-	15,000G2.5	D
2.060	2.750	-	-	0.94	-	S/D	-	Domestic	C50-62EM206-A	\$103.70	SS-9/16-18W-A	-	-	B
2.660	1.813	-	1	0.95	-	-	-	Collis	C50-62EM266-C	\$140.83	-	-	-	B
3.000	1.650	-	-	-	-	-	-	Sowa	C50-62EM300-GB	\$88.74	-	9/16-18	15,000	C
								SpinTru	C50-62EM300-KB	\$88.74	-	-	15,000G2.5	D
3.750	1.620	-	1	0.94	-	-	-	Collis	C50-62EM375-C	\$85.68	SS-64843-C	-	-	C
								Domestic	C50-62EM375-A	\$81.90	SS-9/16-18W-A	-	-	B
								Parlec	C50-62EM375-P	\$81.20	SS-029-918-P	-	-	B
								USST	C50-62EM375-U	\$70.00	SS-029-918-U	-	-	D
4.000	1.650	-	-	-	-	-	-	Sowa	C50-62EM400-GB	\$97.24	-	9/16-18	15,000	C
								SpinTru	C50-62EM400-KB	\$97.24	-	-	15,000G2.5	D

(Additional 5/8" CAT-50 Endmill Holders Are Located On The Following Page)

**Call Us Today For All Of Your Machine Tool Needs!**

# CAT-50 TOOL HOLDERS

## END MILL HOLDERS

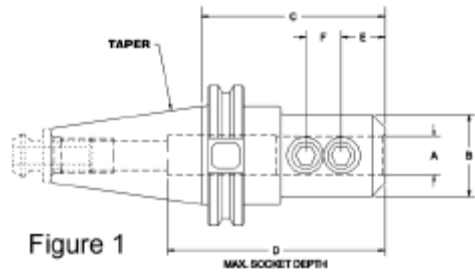

Figure 1

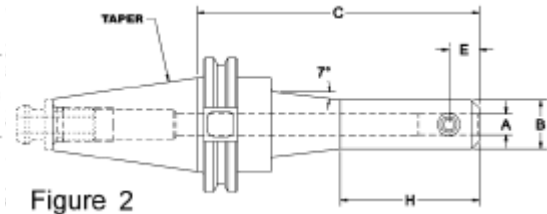

Figure 2

Balanced Toolholders Now Available!



### 5/8" CAT-50 Endmill Holders-5/8" (.6250) Diameter (continued from previous page)

C Proj.	B Outside (Dia.)	D	Fig. No.	E	H Ext. Proj.	End Mill Type	Tight. Torque (ft.lbs.)	Vendor	Part Number	Price Each	Set Screw Part Number	Set Screw Size	MAX RPM Balanced Up To	Code
5.750	1.500	-	-	0.94	-	S / D	-	Domestic	C50-62EM575-A	\$93.10	SS-9/16-18W-A	-	-	B
	1.620	-	1	0.94	-	-	-	Collis	C50-62EM575-C	\$100.59	SS-64843-C	9/16" - 18	-	C
	1.500	3.50	2	0.94	-	S / D	31	Parlec	C50-62EM575-P	\$88.90	SS-029-918-P	9/16" - 18	-	B
6.000	1.650	-	-	-	-	-	-	Sowa	C50-62EM600-GB	\$105.74	-	9/16-18	15,000	C
	-	-	-	-	-	-	-	SpinTru	C50-62EM600-KB	\$105.74	-	-	15,000G2.5	D
7.750	1.500	-	-	0.94	-	S / D	-	Domestic	C50-62EM775-A	\$133.45	SS-9/16-18W-A	-	-	B
	1.620	-	1	0.94	-	-	-	Collis	C50-62EM775-C	\$120.75	SS-64843-C	9/16" - 18	-	C
	1.500	3.50	3	0.94	4.25	S / D	31	Parlec	C50-62EM775-P	\$106.40	SS-029-918-P	9/16" - 18	-	B
8.000	1.650	-	-	-	-	-	-	Sowa	C50-62EM800-GB	\$123.59	-	9/16-18	15,000	C
	-	-	-	-	-	-	-	SpinTru	C50-62EM800-KB	\$123.59	-	-	15,000G2.5	D
9.000	1.060	-	1	1.58	-	-	-	Collis	C50-62EM900-C	\$260.89	-	-	-	C
12.000	1.060	-	1	1.79	-	-	-	Collis	C50-62EM1200-C	\$260.89	-	-	-	C

### 3/4" CAT-50 Endmill Holders-3/4" (.7500) Diameter

C Proj.	B Outside (Dia.)	D	Fig. No.	E	H Ext. Proj.	End Mill Type	Tight. Torque (ft.lbs.)	Vendor	Part Number	Price Each	Set Screw Part Number	Set Screw Size	MAX RPM Balanced Up To	Code
1.375	2.750	-	-	-	-	-	-	Collis	C50-75EM138-C	\$85.68	-	-	-	C
		-	-	-	-	-	-	Collis	C50-75EM138-CB	\$96.88	-	-	15,000G2.5	C
1.620	2.750	4.00	1	1.00	-	S	43	Parlec	C50-75EM162-P	\$84.00	SS-029-925-P	5/8" - 18	-	B
1.750	1.890	-	-	-	-	-	-	Sowa	C50-75EM175-GB	\$88.74	-	5/8-18	15,000	C
		-	-	-	-	-	-	SpinTru	C50-75EM175-KB	\$88.74	-	-	15,000G2.5	D
2.060	2.750	-	-	1.00	-	S / D	-	Domestic	C50-75EM206-A	\$103.70	SS-5/8-18W-A	-	-	B
2.630	2.000	-	1	1.04	-	-	-	Collis	C50-75EM263-C	\$140.83	-	-	-	B
		-	-	-	-	-	-	Sowa	C50-75EM300-GB	\$88.74	-	5/8-18	15,000	C
3.000	1.890	-	-	-	-	-	-	SpinTru	C50-75EM300-KB	\$88.74	-	-	15,000G2.5	D
		-	-	-	-	-	-	Collis	C50-75EM375-C	\$85.68	SS-64844-C	-	-	C
3.750	1.750	-	1	1.00	-	-	-	Domestic	C50-75EM375-A	\$81.90	SS-5/8-18W-A	-	-	B
	1.750	4.00	2	1.00	-	S	43	Parlec	C50-75EM375-P	\$81.20	SS-029-925-P	-	-	B
	1.750	2.30	2	1.00	-	-	-	USST	C50-75EM375-U	\$70.00	SS-029-925-U	-	-	D
4.000	1.890	-	-	-	-	-	-	Sowa	C50-75EM400-GB	\$97.24	-	5/8-18	15,000	C
		-	-	-	-	-	-	SpinTru	C50-75EM400-KB	\$97.24	-	-	15,000G2.5	D
4.500	2.000	-	1	1.04	-	-	-	Collis	C50-75EM450-C	\$156.51	-	-	-	B
5.750	1.750	-	-	1.00	-	S / D	-	Domestic	C50-75EM575-A	\$93.10	SS-5/8-18W-A	-	-	B
	1.750	4.00	2	1.00	-	S / D	43	Parlec	C50-75EM575-P	\$88.90	SS-029-925-P	-	-	B
	1.750	-	1	1.00	-	-	-	Collis	C50-75EM575-C	\$100.59	SS-64844-C	5/8" - 18	-	C
6.000	1.890	-	-	-	-	-	-	Sowa	C50-75EM600-GB	\$105.74	-	5/8-18	15,000	C
		-	-	-	-	-	-	SpinTru	C50-75EM600-KB	\$105.74	-	-	15,000G2.5	D
7.750	1.750	-	1	1.00	-	S / D	-	Domestic	C50-75EM775-A	\$133.45	SS-5/8-18W-A	-	-	B
	1.750	-	1	1.00	-	-	-	Collis	C50-75EM775-C	\$108.08	SS-64844-C	5/8" - 18	-	C
	1.750	4.00	3	1.00	4.25	S / D	43	Parlec	C50-75EM775-P	\$106.40	SS-029-925-P	5/8" - 18	-	B
8.000	1.890	-	-	-	-	-	-	Sowa	C50-75EM800-GB	\$123.59	-	5/8-18	15,000	C
		-	-	-	-	-	-	SpinTru	C50-75EM800-KB	\$123.59	-	-	15,000G2.5	D
9.000	1.190	-	1	1.71	-	-	-	Collis	C50-75EM900-C	\$260.89	-	-	-	C
12.000	1.190	-	1	1.92	-	-	-	Collis	C50-75EM1200-C	\$260.89	-	-	-	C

Call Us Or Visit Our Website For Our Complete Selection!

# CAT-50 TOOL HOLDERS

## END MILL HOLDERS

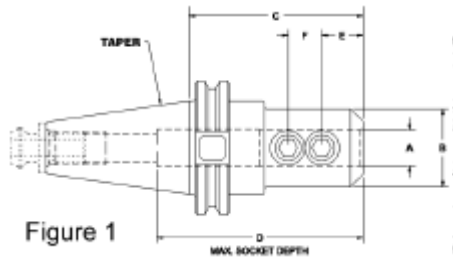

Figure 1

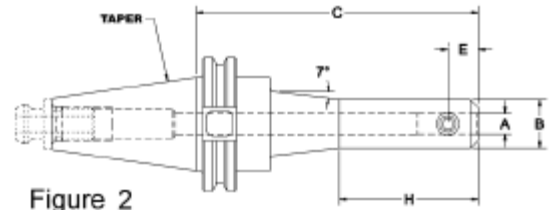

Figure 2



### 7/8" CAT-50 Endmill Holders-7/8" (.8750) Diameter

C Proj.	B Outside (Dia.)	D	Fig. No.	E	H Ext. Proj.	End Mill Type	Tight. Torque (ft.lbs.)	Vendor	Part Number	Price Each	Set Screw Part Number	Set Screw Size	MAX RPM Balanced Up To	Code
1.375	2.750	-	-	-	-	-	-	Collis	C50-87EM138-C	\$85.68	-	-	-	C
								Collis	C50-87EM138-CB	\$96.88	-	-	15,000G2.5	C
1.750	2.000	-	-	-	-	-	-	Sowa	C50-87EM175-GB	\$88.74	-	5/8-18	15,000	C
								SpinTru	C50-87EM175-KB	\$88.74	-	-	15,000G2.5	D
3.750	2.000	4.31	1	1.00	-	-	70	SpinTru	C50-87EM375-KB	\$87.81	-	-	15,000	D
	2.000	-	-	-	-	-	-	Sowa	C50-87EM375-GB	\$87.81	-	5/8-18	15,000	C
	2.000	-	2	1.00	-	-	-	Collis	C50-87EM375-C	\$85.68	SS-64844-C	-	-	C
	2.000	4.00	-	1.00	-	S/D	-	Domestic	C50-87EM375-A	\$101.15	SS-5/8-18W-A	-	-	B
	1.880	4.19	2	1.00	-	S/D	48	Parlec	C50-87EM375-P	\$85.40	SS-029-925-P	-	-	B
	1.880	2.50	2	0.75	-	-	-	USST	C50-87EM375-U	\$70.00	SS-029-925-U	-	-	D
5.750	2.000	4.00	-	1.00	-	S/D	-	Domestic	C50-87EM575-A	\$116.45	SS-5/8-18W-A	-	-	B
	2.000	-	2	1.00	-	-	-	Collis	C50-87EM575-C	\$93.17	SS-64844-C	5/8" - 18	-	C
	1.880	4.19	2	1.00	-	S/D	48	Parlec	C50-87EM575-P	\$99.40	SS-029-925-P	5/8" - 18	-	B
6.000	2.000	-	-	-	-	-	-	Sowa	C50-87EM600-GB	\$105.83	-	5/8-18	15,000	C
	-	-	-	-	-	-	-	SpinTru	C50-87EM600-KB	\$105.83	-	-	15,000G2.5	D
7.750	2.000	4.00	-	1.00	-	S/D	-	Domestic	C50-87EM775-A	\$142.80	SS-5/8-18W-A	-	-	B
	1.880	4.19	3	1.00	4.25	S/D	48	Parlec	C50-87EM775-P	\$106.40	SS-029-925-P	5/8" - 18	-	B
12.000	1.310	-	1	2.04	-	-	-	Collis	C50-87EM1200-C	\$260.89	-	-	-	C
15.000	1.310	-	1	2.25	-	-	-	Collis	C50-87EM1500-C	\$279.51	-	-	-	C

### 1" CAT-50 Endmill Holders-1" (1.000) Diameter

C Proj.	B Outside (Dia.)	D	Fig. No.	E	H Ext. Proj.	End Mill Type	Tight. Torque (ft.lbs.)	Vendor	Part Number	Price Each	Set Screw Part Number	Set Screw Size	MAX RPM Balanced Up To	Code
1.375	2.750	-	-	-	-	-	-	Collis	C50-10EM138-C	\$85.68	-	-	-	C
								Collis	C50-10EM138-CB	\$96.88	-	-	15,000G2.5	C
1.620	2.750	2.50	1	1.12	-	S	69	Parlec	C50-10EM162-P	\$84.00	SS-029-926-P	3/4" - 16	-	B
2.000	2.360	-	-	-	-	-	-	Sowa	C50-10EM200-GB	\$88.74	-	3/4-16	15,000	C
	-	-	-	-	-	-	-	SpinTru	C50-10EM200-KB	\$88.74	-	-	15,000G2.5	D
2.250	2.750	4.50	-	1.12	-	S/D	-	Domestic	C50-10EM225-A	\$109.65	SS-3/4-16W-A	-	-	B
2.620	2.750	-	1	1.12	-	-	-	Collis	C50-10EM262-C	\$85.68	SS-64845-C	3/4" - 16	-	C
3.000	2.625	-	1	1.17	-	-	-	Collis	C50-10EM300-C	\$146.12	SS-64845-C	3/4" - 16	-	B
4.000	2.000	4.56	1	1.13	-	-	110	SpinTru	C50-10EM400-KB	\$90.95	-	-	15,000G2.5	D
	2.250	-	2	1.12	-	-	-	Collis	C50-10EM400-C	\$93.17	SS-64845-C	-	-	C
	2.000	4.50	-	1.12	-	S/D	-	Domestic	C50-10EM400-A	\$83.30	SS-3/4-16W-A	-	-	B
	2.000	4.44	2	1.12	-	S/D	69	Parlec	C50-10EM400-P	\$81.90	SS-029-926-P	-	-	B
	2.360	-	-	-	-	-	-	Sowa	C50-10EM400-GB	\$90.95	-	3/4-16	15,000	C
	2.000	2.83	2	1.12	-	-	-	USST	C50-10EM400-U	\$70.00	SS-029-926-U	-	-	D
4.500	2.625	-	1	1.17	-	-	-	Collis	C50-10EM450-C	\$166.99	SS-64845-C	3/4" - 16	-	B
6.000	2.000	4.56	1	1.13	-	-	110	SpinTru	C50-10EM600-KB	\$106.08	-	-	15,000G2.5	D
	2.000	4.50	-	1.12	-	S/D	-	Domestic	C50-10EM600-A	\$95.90	SS-3/4-16W-A	-	-	B
	2.360	-	-	-	-	-	-	Sowa	C50-10EM600-GB	\$106.08	-	3/4-16	15,000	C
	2.250	-	2	1.12	-	-	-	Collis	C50-10EM600-C	\$100.59	SS-64845-C	3/4" - 16	-	C
	2.000	4.44	2	1.12	-	S/D	69	Parlec	C50-10EM600-P	\$91.70	SS-029-926-P	3/4" - 16	-	B
8.000	2.000	4.56	1	1.13	-	-	110	SpinTru	C50-10EM800-KB	\$123.59	-	-	15,000G2.5	D
	2.000	4.50	-	1.12	-	S/D	-	Domestic	C50-10EM800-A	\$142.80	SS-3/4-16W-A	-	-	B
	2.000	4.44	3	1.12	4.50	S/D	69	Parlec	C50-10EM800-P	\$98.00	SS-029-926-P	-	-	B
	2.360	-	-	-	-	-	-	Sowa	C50-10EM800-GB	\$123.59	-	3/4-16	15,000	C
	2.250	-	2	1.12	-	-	-	Collis	C50-10EM800-C	\$108.08	SS-64845-C	3/4" - 16	-	C
12.000	1.620	-	1	2.34	-	-	-	Collis	C50-10EM1200-C	\$279.51	-	-	-	C
15.000	1.620	-	1	2.55	-	-	-	Collis	C50-10EM1500-C	\$279.51	-	-	-	C

Call Us Today For All Of Your Machine Tool Needs!

# CAT-50 TOOL HOLDERS

## END MILL HOLDERS

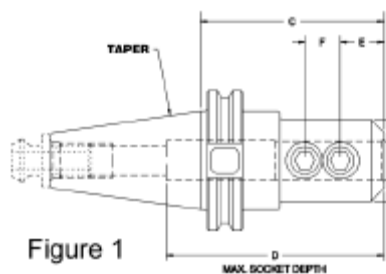

Figure 1

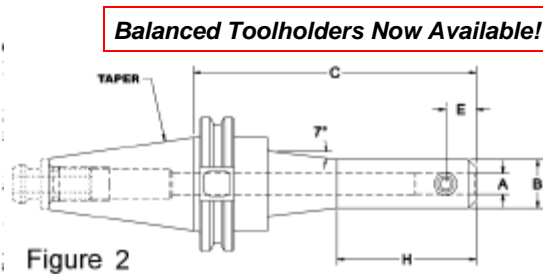

Figure 2

Balanced Toolholders Now Available!



### 1-1/4" CAT-50 Endmill Holders-1 1/4" (1.250) Diameter

C Proj.	B Outside (Dia.)	D	Fig. No.	E	H Ext. Proj.	End Mill Type	Tight. Torque (ft.lbs.)	Vendor	Part Number	Price Each	Set Screw Part Number	Set Screw Size	MAX RPM Balanced Up To	Code
1.375	2.750	-	-	-	-	-	-	Collis	C50-12EM138-C	\$96.88	-	-	-	C
2.000	2.750	-	-	-	-	-	-	Sowa	C50-12EM200-GB	\$101.15	-	3/4-16	15,000	C
	-	-	-	-	-	-	-	SpinTru	C50-12EM200-KB	\$101.15	-	-	15,000G2.5	D
2.250	2.750	2.75	-	1.12	-	S	-	Domestic	C50-12EM225-A	\$120.70	SS-3/4-16W-A	-	-	B
2.620	2.750	3.50	2	1.50	-	S	69	Parlec	C50-12EM262-P	\$90.30	SS-029-922-P	3/4" - 16	-	B
3.000	2.875	-	1	1.17	-	-	-	Collis	C50-12EM300-C	\$146.12	SS-64845-C	3/4" - 16	-	B
4.000	2.500	2.52	2	1.13	0.94	-	110	SpinTru	C50-12EM400-KB	\$106.08	-	-	15,000G2.5	D
	2.500	-	2	1.12	-	-	-	Collis	C50-12EM400-C	\$93.17	SS-64845-C	-	-	C
	2.500	2.50	-	1.12	-	S	-	Domestic	C50-12EM400-A	\$93.80	SS-3/4-16W-A	-	-	B
	2.500	3.35	2	1.12	-	S / D	69	Parlec	C50-12EM400-P	\$89.60	SS-029-922-P	-	-	B
	2.480	-	-	-	-	-	-	Sowa	C50-12EM400-GB	\$106.08	-	3/4-16	15,000	C
4.150	2.500	3.00	2	1.12	-	-	-	USST	C50-12EM415-U	\$70.00	SS-029-921-U	-	-	D
6.000	2.500	2.52	2	1.13	0.94	-	110	SpinTru	C50-12EM600-KB	\$117.56	-	-	15,000G2.5	D
	2.500	2.50	-	1.12	-	S	-	Domestic	C50-12EM600-A	\$107.80	SS-3/4-16W-A	-	-	B
	2.480	-	-	-	-	-	-	Sowa	C50-12EM600-GB	\$117.56	-	3/4-16	15,000	C
	2.500	-	2	1.12	-	-	-	Collis	C50-12EM600-C	\$100.59	SS-64845-C	3/4" - 16	-	C
	2.500	3.35	2	1.12	-	S / D	69	Parlec	C50-12EM600-P	\$97.30	SS-029-922-P	3/4" - 16	-	B
8.000	2.500	2.52	2	1.13	0.94	-	110	SpinTru	C50-12EM800-KB	\$135.32	-	-	15,000G2.5	D
	2.500	2.50	-	1.12	-	S	-	Domestic	C50-12EM800-A	\$147.05	SS-3/4-16W-A	-	-	B
	2.480	-	-	-	-	-	-	Sowa	C50-12EM800-GB	\$135.32	-	3/4-16	15,000	C
	2.500	-	2	1.12	-	-	-	Collis	C50-12EM800-C	\$108.08	SS-64845-C	3/4" - 16	-	C
	2.500	3.35	2	1.12	-	S / D	69	Parlec	C50-12EM800-P	\$109.90	SS-029-922-P	3/4" - 16	-	B
12.000	1.880	-	1	2.60	-	-	-	Collis	C50-12EM1200-C	\$279.51	-	-	-	C
15.000	1.880	-	1	2.75	-	-	-	Collis	C50-12EM1500-C	\$279.51	-	-	-	C

### 1-1/2" CAT-50 Endmill Holders-1 1/2" (1.500) Diameter

C Proj.	B Outside (Dia.)	D	Fig. No.	E	H Ext. Proj.	End Mill Type	Tight. Torque (ft.lbs.)	Vendor	Part Number	Price Each	Set Screw Part Number	Set Screw Size	MAX RPM Balanced Up To	Code
2.250	2.750	-	-	-	-	-	-	Sowa	C50-15EM225-GB	\$101.15	-	3/4-16	15,000	C
	-	-	-	-	-	-	-	SpinTru	C50-15EM225-KB	\$101.15	-	-	15,000G2.5	D
2.620	2.750	2.25	2	1.50	-	S	69	Parlec	C50-15EM262-P	\$109.90	SS-029-922-P	3/4" - 16	-	B
2.750	2.750	2.75	-	1.12	-	S	-	Domestic	C50-15EM275-A	\$125.80	SS-3/4-16W-A	-	-	B
4.000	2.750	2.75	-	1.50	-	S	-	Domestic	C50-15EM400-A	\$99.40	SS-3/4-16W-A	-	-	B
	2.750	-	2	1.12	-	-	-	Collis	C50-15EM400-C	\$96.88	SS-64845-C	3/4" - 16	-	C
	2.750	4.50	2	1.12	-	S / D	69	Parlec	C50-15EM400-P	\$97.30	SS-029-922-P	3/4" - 16	-	B
4.500	2.990	-	-	-	-	-	-	Sowa	C50-15EM450-GB	\$106.08	-	3/4-16	15,000	C
	-	-	-	-	-	-	-	SpinTru	C50-15EM450-KB	\$106.08	-	-	15,000G2.5	D
6.000	2.750	2.75	-	1.50	-	S	-	Domestic	C50-15EM600-A	\$135.15	SS-3/4-16W-A	-	-	B
	2.750	-	2	1.12	-	-	-	Collis	C50-15EM600-C	\$104.37	SS-64845-C	3/4" - 16	-	C
	2.750	4.50	2	1.12	-	S / D	69	Parlec	C50-15EM600-P	\$114.10	SS-029-922-P	3/4" - 16	-	B
7.000	2.990	-	-	-	-	-	-	Sowa	C50-15EM700-GB	\$123.34	-	3/4-16	15,000	C
	-	-	-	-	-	-	-	SpinTru	C50-15EM700-KB	\$123.34	-	-	15,000G2.5	D
8.000	2.750	2.75	-	1.50	-	S	-	Domestic	C50-15EM800-A	\$147.05	SS-3/4-16W-A	-	-	B
	2.750	-	2	1.12	-	-	-	Collis	C50-15EM800-C	\$119.28	SS-64845-C	3/4" - 16	-	C
	2.750	4.50	2	1.12	-	S / D	69	Parlec	C50-15EM800-P	\$126.00	SS-029-922-P	3/4" - 16	-	B
9.000	2.990	-	-	-	-	-	-	Sowa	C50-15EM900-GB	\$140.17	-	3/4-16	15,000	C
	-	-	-	-	-	-	-	SpinTru	C50-15EM900-KB	\$140.17	-	-	15,000G2.5	D
12.000	2.250	-	1	2.96	-	-	-	Collis	C50-15EM1200-C	\$279.51	-	-	-	C
15.000	2.250	-	1	3.17	-	-	-	Collis	C50-15EM1500-C	\$279.51	-	-	-	C

Call Us Or Visit Our Website For Our Complete Selection!

# CAT-50 TOOL HOLDERS

## END MILL HOLDERS

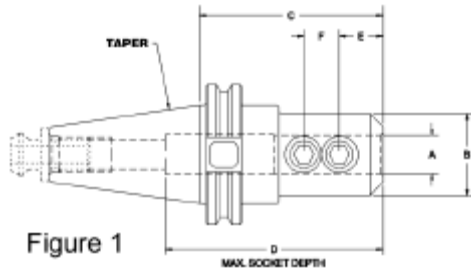

Figure 1

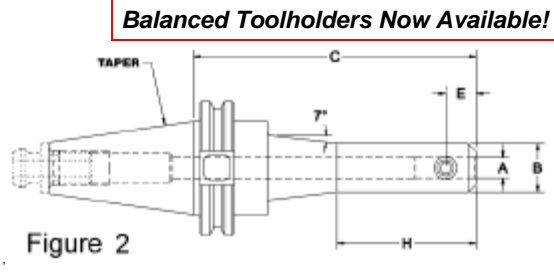

Figure 2

Balanced Toolholders Now Available!



### 1-3/4" CAT-50 Endmill Holders-1 3/4" (1.750) Diameter

C Proj.	B Outside (Dia.)	D	Fig. No.	E	H Ext. Proj.	End Mill Type	Tight. Torque (ft.lbs.)	Vendor	Part Number	Price Each	Set Screw Part Number	Set Screw Size	MAX RPM Balanced Up To	Code
4.000	3.120	2.75		1.12	-	S	-	Domestic	C50-17EM400-A	\$170.00	SS-3/4-16W-A	-	-	B

### 2" CAT-50 Endmill Holders-2" (2.000) Diameter

C Proj.	B Outside (Dia.)	D	Fig. No.	E	H Ext. Proj.	End Mill Type	Tight. Torque (ft.lbs.)	Vendor	Part Number	Price Each	Set Screw Part Number	Set Screw Size	MAX RPM Balanced Up To	Code
1.000	-	-	-	-	-	-	-	SpinTru	C50-20EM1000-KB	\$150.11	-	-	15,000G2.5	D
3.630	3.740	-	-	-	-	-	-	Sowa	C50-20EM363-GB	\$118.41	-	1"-14	15000	C
3.750	-	-	-	-	-	-	-	SpinTru	C50-20EM363-KB	\$118.41	-	-	15,000G2.5	D
3.750	3.750	-	2	1.25	-	-	-	Collis	C50-20EM375-C	\$177.38	SS-64845-C	3/4" - 16	-	B
5.370	3.740	-	-	-	-	-	-	Sowa	C50-20EM537-GB	\$129.88	-	1"-14	15000	C
5.370	-	-	-	-	-	-	-	SpinTru	C50-20EM537-KB	\$129.88	-	-	15,000G2.5	D
5.620	3.750	3.50	-	1.41	-	S	-	Domestic	C50-20EM562-A	\$140.00	SS-1-14W-A	-	-	B
5.620	3.750	-	2	1.38	-	-	-	Collis	C50-20EM562-C	\$141.61	SS-64846-C	1" - 14	-	C
5.620	3.750	3.50	2	1.41	-	S	125	Parlec	C50-20EM562-P	\$131.60	SS-029-928-P	1" - 14	-	B
7.620	3.750	3.50	-	1.41	-	S	-	Domestic	C50-20EM762-A	\$187.00	SS-1-14W-A	-	-	B
7.620	3.750	-	2	1.38	-	-	-	Collis	C50-20EM762-C	\$149.10	SS-64846-C	1" - 14	-	C
7.620	3.750	3.50	2	1.41	-	S	125	Parlec	C50-20EM762-P	\$175.00	SS-029-928-P	1" - 14	-	B
8.000	3.740	-	-	-	-	-	-	Sowa	C50-20EM800-GB	\$142.55	-	1"-14	15000	C
8.000	-	-	-	-	-	-	-	SpinTru	C50-20EM800-KB	\$142.55	-	-	15,000G2.5	D
9.620	3.750	3.50	-	1.41	-	S	-	Domestic	C50-20EM962-A	\$215.90	SS-1-14W-A	-	-	B
9.620	3.750	3.50	2	1.41	-	S	125	Parlec	C50-20EM962-P	\$183.40	SS-029-928-P	1" - 14	-	B
10.000	3.740	-	-	-	-	-	-	Sowa	C50-20EM1000-GB	\$150.11	-	1"-14	15000	C

### 2-1/2" CAT-50 Endmill Holders-2 1/2" (2.500) Diameter

C Proj.	B Outside (Dia.)	D	Fig. No.	E	H Ext. Proj.	End Mill Type	Tight. Torque (ft.lbs.)	Vendor	Part Number	Price Each	Set Screw Part Number	Set Screw Size	MAX RPM Balanced Up To	Code
6.000	4.250	-	-	-	-	-	-	Sowa	C50-250EM600-GB	\$167.79	-	1"-14	15000	C
6.000	4.250	-	2	1.56	-	-	-	Collis	C50-250EM600-C	\$156.52	SS-64846-C	1" - 14	-	C
6.000	-	-	-	-	-	-	-	SpinTru	C50-250EM600-KB	\$167.79	-	-	15,000G2.5	D
6.500	4.000	4.00	2	1.50	-	S	125	Parlec	C50-250EM650-P	\$180.60	SS-029-928-P	1" - 14	-	B
6.500	4.000	4.00	2	1.50	-	S	125	Parlec	C50-250EM650-P	\$180.60	SS-029-928-P	1" - 14	-	B

## TOOLHOLDER TIGHTENING FIXTURES



Collis Tightening Fixtures

Taper	Height	Dia.	Part Number	Price Each
30	2 3/4	2	C30-84961-C	\$129.36
35	2 3/4	4	C35-84992-C	\$162.68
40	4	3 1/8	C40-84991-C	\$145.04
50	4	5 3/4	C50-84993-C	\$168.56

### FEATURES:

- Access both ends of your toolholders simultaneously
- Minimize toolholder handling
- Speed up your operation
- Convenient, practical and easy to use

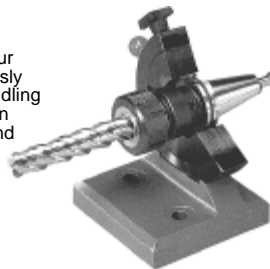

Flange Type	Weight (lbs)	Part Number	Price Each
BT-30	17	LY-B30-TOOLJAW	
BT-40	17	LY-B40-TOOLJAW	\$284.20
CAT-40	17	LY-C40-TOOLJAW	\$284.20
CAT-50	17	LY-C50-TOOLJAW	\$284.20

## XYZ SETTER

### FEATURES:

- Easy, accurate setting of any axis
- Precisely establish all primary references quickly and dependably.
- Minimize you setup time and maximize production time
- Available for either front or side reading
- Precision made of ground, hardened tool steel
- Dial indicators graduated in



Description	Weight (lbs)	Part Number	Price Each
Front Reading	1.5	LY-XYZ-A	\$460.00
Side Reading	1.5	LY-XYZ-B	\$460.00

Call Us Today For All Of Your Machine Tool Needs!

# CAT-50 TOOL HOLDERS

## END MILL HOLDERS

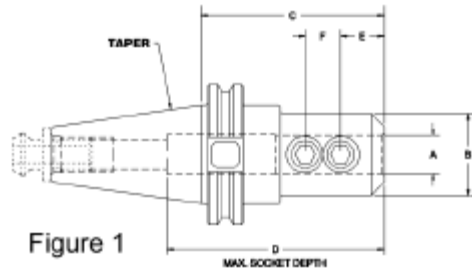

Figure 1

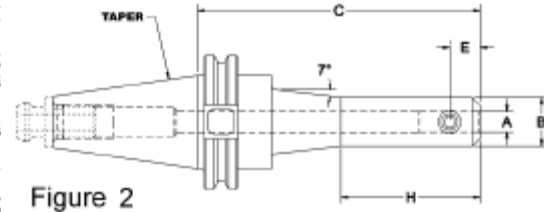

Figure 2



### METRIC CAT-50 Metric Endmill Holders-6mm to 40mm

A Inside Dia	C Proj.	B Outside (Dia.)	D	Fig. No.	E	End Mill Type	Tight. Torque (ft.lbs.)	Vendor	Part Number	Price Each	Set Screw Part Number	Set Screw Size	Code
6MM	2.500	0.875	-	-	0.44	S / D	-	Domestic	C50-M06EM250-A	\$130.90	SS-M6 W-A	-	B
	2.500	0.880	4.25	2	0.44	S / D	7	Parlec	C50-M06EM250-P	\$94.50	SS-029-018-P	1/4" - 28	B
8MM	2.500	1.000	-	-	0.44	S / D	-	Domestic	C50-M08EM250-A	\$126.65	SS-M8 W-A	-	B
	2.500	1.000	4.25	2	0.44	S / D	9	Parlec	C50-M08EM250-P	\$94.50	SS-029-018-P	1/4" - 28	B
10MM	2.500	1.000	-	-	0.74	S / D	-	Domestic	C50-M10EM250-A	\$126.65	SS-M10 W-A	-	B
	2.500	1.000	4.25	2	0.75	S / D	12	Parlec	C50-M10EM250-P	\$94.50	SS-029-902-P	3/8" - 24	B
12MM	2.620	1.250	-	-	0.88	S / D	-	Domestic	C50-M12EM262-A	\$126.65	SS-M12 W-A	-	B
	2.620	1.250	4.38	2	0.88	S / D	17	Parlec	C50-M12EM262-P	\$94.50	SS-029-917-P	7/8" - 20	B
16MM	3.750	1.500	-	-	0.94	S / D	-	Domestic	C50-M16EM375-A	\$130.90	SS-M16 W-A	-	B
	3.750	1.500	2.13	2	0.94	S	31	Parlec	C50-M16EM375-P	\$105.70	SS-029-918-P	9/16" - 18	B
20MM	3.750	1.750	-	-	1.00	S / D	-	Domestic	C50-M20EM375-A	\$130.90	SS-M16 W-A	-	B
	3.750	1.750	2.25	2	1.00	S	43	Parlec	C50-M20EM375-P	\$105.70	SS-029-925-P	5/8" - 18	B
25MM	4.000	2.000	4.50	-	1.12	S / D	-	Domestic	C50-M25EM400-A	\$130.90	SS-M20 W-A	-	B
	4.000	2.350	-	2	1.13	-	-	Collis	C50-M25EM400-C	\$105.84	SS-64845-C	3/4" - 16	C
32MM	4.000	2.000	3.00	2	1.13	S	69	Parlec	C50-M25EM400-P	\$105.70	SS-029-926-P	3/4" - 16	B
	4.000	2.500	2.52	-	1.12	S	-	Domestic	C50-M32EM400-A	\$153.85	SS-M20 W-A	-	B
40MM	4.000	2.000	-	2	1.13	-	-	Collis	C50-M32EM400-C	\$105.84	SS-64845-C	3/4" - 16	C
	4.000	2.500	2.60	2	1.13	S	69	Parlec	C50-M32EM400-P	\$105.70	SS-029-922-P	3/4" - 16	B
40MM	4.000	2.750	3.25	2	1.13	S	69	Parlec	C50-M40EM400-P	\$105.70	SS-029-922-P	3/4" - 16	B
	4.500	3.060	-	2	1.13	-	-	Collis	C50-M40EM450-C	\$118.51	SS-64845-C	3/4" - 16	C

## DRAWBAR CLAMPING FORCE GAGE

CNC Machines using pull-studs for tool retention experience a slow but progressive loss of tool holding pressure from the time the machine is new. This little known fact has a major impact on surface finishes, cutting tool life, and on your productivity. Testing a drawbar requires a force gage which simulates a tool being held in the spindle. **The Clamprite Gage** uses a common tool holder as the interface between the gage and machine spindle, eliminating the need for a high-priced precision adapter for each different spindle size (only HSK-type spindles require an adapter).

### Low drawbar force can result in:

- Reduced cutter life
- Chatter and rough finishes
- Difficulty with repeatability
- Lower feeds and productivity
- Rapid wear of toolholder and spindle tapers

**Accuracy Traceable to NIST-Suitable for ISO 9000 Shops!**

**The Clamprite Gage** was designed for accurate spindle tension testing right on the machine. The actual pressure exerted by the spindle drawbar mechanism is read directly on the dial, so there is never a need for any calculations or conversions. Drawbar force checking is made easy using the Clamprite drawbar force gage. Drawbar testing takes less than one minute, so production time is barely affected. Its simple and rugged design requires no batteries, electrical cords, or delicate electronic components to pre-set, calibrate, or burn out.

### FEATURES:

- Test drawbar force in less than one minute
- Reads directly in lbs of force- no calculating
- Rugged, reliable and works on all machines
- Helps to prevent unscheduled maintenance
- HSK models also available
- Made in USA



HSK Models Also Available!



Protect Your Spindles!

Prevent Unscheduled Maintenance!

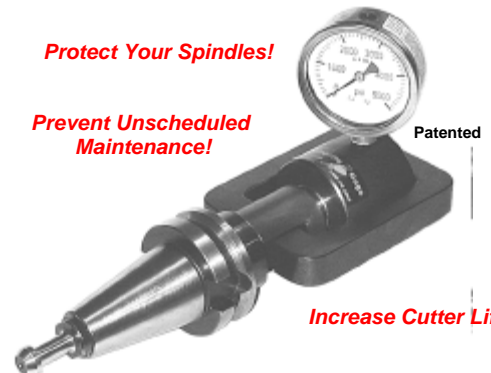

Increase Cutter Life!

Description	PSI Lbs	Part Number	Price Each
Clamprite Gage	3,000	CR-D1001-1	\$ 595.00
	5,000	CR-D1001-2	\$ 595.00
	10,000	CR-D1001-3	\$ 629.00

Call Us Or Visit Our Website For Our Complete Selection!

# CAT-50 TOOL HOLDERS

## ER SERIES COLLET CHUCKS

Balanced Toolholders Now Available!

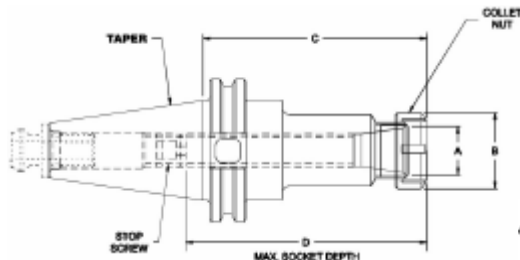

ER COLLETS  
are on pages  
155-158



C Proj.	L1	B Nut Dia.	D Socket Depth	Nut Tight. Torque (ft.lbs.)	Vendor	Part Number	Price Each	MAX RPM Balanced Up To	Collet Nut	Wrench	Stop Screw	Code
---------	----	------------	----------------	-----------------------------	--------	-------------	------------	------------------------	------------	--------	------------	------

ER 16 ER-16 Collet Series-.020 - 0.393 (0.5mm - 10mm)														
3.00	-	1.10	1.94	-	Collis	C50-16ER300-C	\$141.61	-	CN-160 CN-161 (split ring)	WR-160	64766	C		
4.00	-	1.10	3.00	-	Domestic	C50-16ER400-A	\$141.40	-			7/16-LH	B		
4.12	-	1.10	2.62	52	Parlec	C50-16ER412-P	\$133.70	-	15,000 15,000G2.5	-	-	BS-20	B	
	1.26	1.10	-	-	Sowa	C50-16ER412-GB	\$148.33	-				-	-	C
-	1.10	2.76	45	SpinTru	C50-16ER412-KB	\$148.33	-	-				-	-	D
-	1.10	-	-	USST	C50-16ER493-U	\$110.00	-	-				-	-	-
5.00	-	1.10	2.68	-	Collis	C50-16ER500-C	\$101.36	-	CN-160 CN-161 (split ring)	WR-160	64766	C		
	-	1.10	3.00	-	Domestic	C50-16ER500-A	\$145.60	-			7/16-LH	B		
6.00	1.26	1.10	-	-	Sowa	C50-16ER600-GB	\$160.82	15,000	-	-	-	C		
6.12	-	1.10	2.62	52	Parlec	C50-16ER612-P	\$142.10	-	CN-160 / CN-161 (split ring)	WR-160	BS-20	B		
7.00	-	1.10	3.00	-	Domestic	C50-16ER700-A	\$157.50	-			7/16-LH	B		
8.00	1.26	1.10	-	-	Sowa	C50-16ER800-GB	\$184.54	15,000	-	-	-	C		
	-	1.10	2.76	45	SpinTru	C50-16ER800-KB	\$184.54	15,000G2.5	-	-	-	D		

ER 20 ER-20 Collet Series-.020 - 0.500 (0.5mm - 12.7mm)												
2.50	1.38	1.35	-	-	Sowa	C50-20ER250-GB	\$149.09	15,000	-	-	-	C
	-	1.35	3.15	50	SpinTru	C50-20ER250-KB	\$149.09	15,000G2.5	-	-	-	D
3.00	-	1.35	2.38	-	Collis	C50-20ER300-C	\$149.10	-	CN-200	WR-200	64768	C
4.00	-	1.35	2.38	-	Collis	C50-20ER400-C	\$149.10	-			WR-200	64768
	-	1.35	3.00	-	Domestic	C50-20ER400-A	\$151.20	-	WR-200	9/16-LH	B	
	1.38	1.35	-	-	Sowa	C50-20ER400-GB	\$149.09	15,000	-	-	-	C
	-	1.35	-	-	USST	C50-20ER400-U	\$110.00	-	-	-	-	D
4.12	-	1.35	4.00	74	Parlec	C50-20ER412-P	\$143.50	-	WR-200	BS-09	B	
6.00	138.00	1.35	-	-	Sowa	C50-20ER600-GB	\$164.65	15,000	-	-	-	C
	-	1.35	2.32	-	Collis	C50-20ER600-C	\$164.01	-	CN-200	WR-200	64768	C
-	1.35	3.00	-	Domestic	C50-20ER600-A	\$165.20	-	WR-200			9/16-LH	B
6.12	-	1.35	4.00	74	Parlec	C50-20ER612-P	\$154.70	-	WR-200	BS-09	B	
8.00	1.38	1.35	-	-	Sowa	C50-20ER800-GB	\$185.47	15,000	-	-	-	C
	-	1.35	3.15	50	SpinTru	C50-20ER800-KB	\$185.47	15,000G2.5	-	-	-	D
8.12	-	1.35	4.00	74	Parlec	C50-20ER812-P	\$172.20	-	WR-200	BS-09	B	

ER 25 ER-25 Collet Series-.039 - 0.630 (1mm - 16mm)												
2.50	1.65	1.65	-	-	Sowa	C50-25ER250-GB	\$152.83	15,000	-	-	-	C
	-	1.65	3.93	100	SpinTru	C50-25ER250-KB	\$152.83	15,000G2.5	-	-	-	D
4.00	-	1.65	3.00	-	Collis	C50-25ER400-C	\$149.10	-	CN-250	WR-250	64770	C
	-	1.65	3.00	-	Domestic	C50-25ER400-A	\$183.60	-			WR-250	5/8-LH
	1.65	1.65	-	-	Sowa	C50-25ER400-GB	\$152.83	15,000	-	-	-	C
	-	1.65	-	-	USST	C50-25ER400-U	\$110.00	-	-	-	-	D
4.12	-	1.65	4.00	95	Parlec	C50-25ER412-P	\$146.30	-	WR-250	BS-11	B	
6.00	1.65	1.65	-	-	Sowa	C50-25ER600-GB	\$164.82	15,000	-	-	-	C
	-	1.65	3.00	-	Collis	C50-25ER600-C	\$164.01	-	CN-250	WR-250	64770	C
-	1.65	3.00	-	Domestic	C50-25ER600-A	\$200.60	-	WR-250			5/8-LH	B
6.12	-	1.65	4.00	95	Parlec	C50-25ER612-P	\$156.80	-	WR-250	BS-11	B	
8.00	1.65	1.65	-	-	Sowa	C50-25ER800-GB	\$188.96	15,000	-	-	-	C
	-	1.65	3.00	-	Collis	C50-25ER800-C	\$178.92	-	WR-250	64770	C	
8.12	-	1.65	4.00	95	Parlec	C50-25ER812-P	\$173.60	-	WR-250	BS-11	B	

Call Us Today For All Of Your Machine Tool Needs!

# CAT-50 TOOL HOLDERS

## ER SERIES COLLET CHUCKS

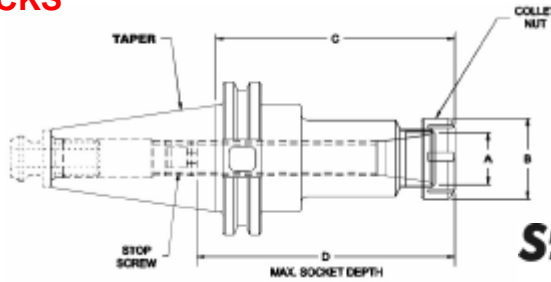

**ER COLLETS**  
are on pages  
155-158



C Proj.	L1	B Nut Dia.	D Socket Depth	Nut Tight. Torque (ft.lbs.)	Vendor	Part Number	Price Each	MAX RPM Balanced Up To	Collet Nut	Wrench	Stop Screw	Code
<b>ER 32 ER-32 Collet Series-.040 - 0.810 (1mm - 20.6mm)</b>												
3.94	-	1.97	-	-	USST	C50-32ER394-U	\$110.00	-	CN-320	WR-320	-	D
	-	1.97	3.00	-	Domestic	C50-32ER394-A	\$151.20	-			7/8-LH	B
4.00	-	1.97	4.24	-	Collis	C50-32ER400-C	\$149.10	-	CN-320	WR-320	64769	C
	1.97	1.97	-	-	Sowa	C50-32ER400-GB	\$154.87	15,000			-	-
4.12	-	1.97	4.00	125	Parlec	C50-32ER412-P	\$147.70	-	CN-320	WR-320	BS-18	B
6.00	1.97	1.97	-	-	Sowa	C50-32ER600-GB	\$159.55	15,000	-	-	-	C
	-	1.97	4.00	-	Collis	C50-32ER600-C	\$164.01	-	CN-320	WR-320	64769	C
6.12	-	1.97	3.00	125	Parlec	C50-32ER612-P	\$158.20	-	CN-320	WR-320	BS-18	B
6.30	-	1.97	3.00	-	Domestic	C50-32ER630-A	\$200.60	-	CN-320	WR-320	7/8-LH	B
8.00	1.97	1.97	-	-	Sowa	C50-32ER800-GB	\$191.93	15,000	-	-	-	C
	-	1.97	3.94	125	SpinTru	C50-32ER800-KB	\$191.93	15,000G2.5	-	-	-	D
8.12	-	1.97	4.00	125	Parlec	C50-32ER812-P	\$172.20	-	CN-320	WR-320	BS-18	B

<b>ER 40 ER-40 Collet Series-.040 - 0.810 (1mm - 20.6mm)</b>												
3.00	-	2.48	3.85	-	Collis	C50-40ER300-C	\$164.01	-	CN-400	WR-400	64760	C
3.94	-	2.48	-	-	USST	C50-40ER394-U	\$110.00	-	CN-400	WR-400	-	D
	-	2.48	3.00	-	Domestic	C50-40ER394-A	\$170.10	-			1-1/8-LH	B
4.00	2.48	2.48	-	-	Sowa	C50-40ER400-GB	\$160.06	15,000	-	-	-	C
4.12	-	2.48	4.00	162	Parlec	C50-40ER412-P	\$168.00	-	CN-400	WR-400	BS-10	B
6.00	2.48	2.48	-	-	Sowa	C50-40ER600-GB	\$172.47	15,000	-	-	-	C
	-	2.48	4.60	-	Collis	C50-40ER600-C	\$164.01	-	CN-400	WR-400	64760	C
6.12	-	2.48	4.00	162	Parlec	C50-40ER612-P	\$184.80	-	CN-400	WR-400	BS-10	B
6.30	-	2.48	3.00	-	Domestic	C50-40ER630-A	\$221.00	-	CN-400	WR-400	1-1/8-LH	B
8.00	2.48	2.48	-	-	Sowa	C50-40ER800-GB	\$197.80	15,000	-	-	-	C
	-	2.48	5.91	160	SpinTru	C50-40ER800-KB	\$197.80	15,000G2.5	-	-	-	D
8.12	-	2.48	4.00	162	Parlec	C50-40ER812-P	\$218.40	-	CN-400	WR-400	BS-10	B

<b>ER 50 ER-50 Collet Series-.394 - 1.339 (1mm - 20.6mm)</b>												
3.94	-	3.07	3.00	-	Domestic	C50-50ER394-A	\$226.95	-	CN-500	WR-500	1-1/2-LH	B

## ER COLLET SETS

- Available in ER 8, 11, 16, 20, 25, 32 & 40 series **INCH & Metric Sizes**
- Comes in attractive collet holder
- For our full selection of individual ER Collets, please see pages 155-157

### Accu-Collets

Fractional Collets  
Manufactured Specifically  
To US Market Requirements!  
Use "On Size" Collet  
For Best Results!



### Inch & Metric Size ER Collet Sets

Type	Style	Description	No. Of Collets	Part Number	Set Price
ER-8	Metric	1mm to 5mm x .5mm	9	08-SET9	\$99.00
	Inch	1/16"-3/16" x 1/64"	9	08-SET9-INCH	\$99.00
ER-11	Metric	1mm to 7mm x .5mm	13	11-SET13	\$143.00
	Inch	1/16"-1/4" x 1/32"	7	11-SET7-INCH	\$77.00
ER-16	Metric	1mm to 10mm x 1mm	10	16-SET10	\$110.00
	Inch	1/16" - 3/8" x 1/32"	11	16-SET11-INCH	\$121.00
ER-20	Metric	1mm to 13mm x 1mm	12	20-SET12	\$144.00
	Inch	1/16" - 1/2" x 1/32"	15	20-SET15-INCH	\$180.00
ER-25	Metric	2mm to 16mm x 1mm	15	25-SET15	\$180.00
	Inch	1/16" - 5/8" x 1/32"	18	25-SET18-INCH	\$216.00
ER-32	Metric	3mm to 20mm x 1mm	18	32-SET18	\$216.00
	Inch	1/8"-3/4" x 1/32"	21	32-SET21-INCH	\$252.00
ER-40	Metric	4mm to 26mm x 1mm	23	40-SET23	\$345.00
	Inch	1/8"-1" x 1/64"	15	40-SET15-INCH	\$225.00
	Inch	1/8" - 1" x 1/32"	29	40-SET29-INCH	\$435.00

Call Us Or Visit Our Website For Our Complete Selection!

# CAT-50 TOOL HOLDERS

## TG COLLET CHUCKS

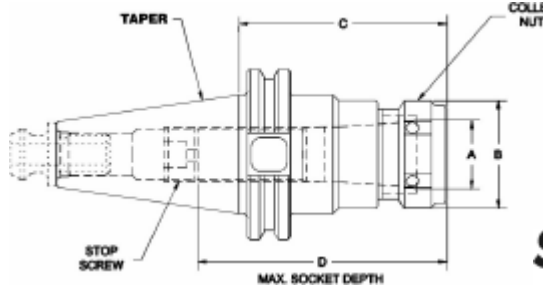

Balanced Toolholders Now Available!



**TG COLLETS**  
are on  
pages 162-163



C Proj.	B Nut Dia.	D Socket Depth	Nut Tight. Torque (ft.lbs.)	Vendor	Part Number	Price Each	MAX RPM Balanced Up To	Collet Nut	Wrench	Stop Screw	Code
<b>TG100 TG-100 Collet Series-5/64 to 1" (2mm - 25.4mm)</b>											
3.00	2.44	4.75	-	Collis	C50-10SC300-C	\$111.79	-	CN-108	WR-108	64760	C
	2.44	4.50	-	Domestic	C50-10SC300-A	\$103.60	-			1-1/8-LH	B
	2.44	4.00	60	Parlec	C50-10SC300-P	\$100.10	-			BS-10	B
	2.43	-	-	USST	C50-10TG300-U	\$95.00	-			-	D
3.50	2.44	4.25	60	Parlec	C50-10SC350-P	\$100.80	-	CN-108	WR-108	BS-10	B
	-	-	-	Sowa	C50-10SC350-GB	\$98.09	15,000	-	-	-	C
	2.44	5.25	-	Collis	C50-10SC350-C	\$111.79	-	CN-108	WR-108	64760	C
5.50	2.44	5.50	60	Parlec	C50-10SC550-P	\$109.20	-	-	-	BS-10	B
	-	-	-	Sowa	C50-10SC550-GB	\$129.46	15,000	-	-	-	C
	2.44	7.25	-	Collis	C50-10SC550-C	\$122.99	-	CN-108	WR-108	64760	C
	2.44	7.00	-	Domestic	C50-10SC550-A	\$115.50	-	CN-108	WR-108	1-1/8-LH	B
7.50	-	-	-	Sowa	C50-10SC750-GB	\$142.04	15,000	-	-	-	C
	2.44	9.00	-	Collis	C50-10SC750-C	\$149.10	-	CN-108	WR-108	64760	C
	2.44	9.00	-	Domestic	C50-10SC750-A	\$125.30	-	CN-108	WR-108	1-1/8-LH	B
10.00	2.44	5.50	60	Parlec	C50-10SC750-P	\$119.70	-	CN-108	WR-108	BS-10	B
	-	-	-	Sowa	C50-10SC1000-GB	\$154.70	15,000	-	-	-	C

<b>TG150 TG-150 Collet Series-23/64 to 1-1/2" (9.1mm - 38.1mm)</b>											
3.00	3.25	4.50	-	Domestic	C50-15SC300-A	\$193.80	-	CN-158	WR-158	1-5/8-LH	B
	3.43	3.50	70	Parlec	C50-15SC300-P	\$161.70	-			BS-15	B
3.50	-	-	-	Sowa	C50-15SC350-GB	\$133.45	15,000	-	-	-	C
	3.25	5.00	-	Collis	C50-15SC350-C	\$141.61	-	CN-158	WR-158	64762	C
	3.43	4.00	70	Parlec	C50-15SC350-P	\$161.70	-	-	-	BS-15	B
5.00	3.25	7.00	-	Domestic	C50-15SC500-A	\$190.40	-	CN-158	WR-158	1-5/8-LH	B
5.50	3.25	7.00	-	Collis	C50-15SC550-C	\$156.52	-	CN-158	WR-158	64762	C
	3.43	5.89	70	Parlec	C50-15SC550-P	\$165.20	-			BS-15	B
6.00	-	-	-	Sowa	C50-15SC600-GB	\$146.80	15,000	-	-	-	C
7.00	3.25	9.00	-	Domestic	C50-15SC700-A	\$225.25	-	CN-158	WR-158	1-5/8-LH	B
7.50	3.43	5.89	70	Parlec	C50-15SC750-P	\$173.60	-			BS-15	B

<b>TG200 TG-200 Collet Series-1" to 2" (25.4mm - 50.8mm)</b>											
4.00	4.25	5.25	-	Domestic	C50-20SC400-A	\$360.40	-	CN-208	WR-208	2-1/8-LH	B

## TG COLLET SETS

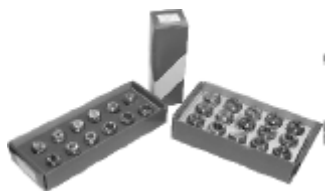

- Available in TG75, 100 & 150 series
- Comes with attractive collet holder
- For our full selection of individual TG Collets, please see pages 161-162

**Accu-Collets**

Set Qty	Range	Part Number	Set Price
59	3/32"-1" -64ths	100-SET59	\$885.00
41	3/8"-1" -64ths	100-SET41	\$615.00
30	3/32"-1" -32nds	100-SET30	\$450.00
21	3/8"-1" -32nds	100-SET21	\$315.00
15	1/8"-1" -16ths	100-SET15	\$225.00

Call Us Today For All Of Your Machine Tool Needs!

# CAT-50 TOOL HOLDERS

## DA COLLET CHUCKS

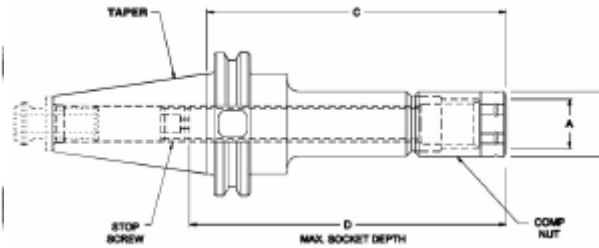

DA COLLETS  
are on  
page 161



C Proj.	B Nut Dia.	D Socket Depth	Nut Tight. Torque (ft.lbs.)	Vendor	Part Number	Price Each	Collet Nut	Wrench	Stop Screw	Code
<b>DA 100 DA100 Collet Series-.062 - 0.562 (1.587mm - 14.287mm)</b>										
3.00	1.39	3.00	-	Domestic	C50-10DA300-A	\$148.75	CN-100	WR-100	5/8-LH	B
6.00	1.39	3.00	-	Domestic	C50-10DA600-A	\$194.65			5/8-LH	B

C Proj.	B Nut Dia.	D Socket Depth	Nut Tight. Torque (ft.lbs.)	Vendor	Part Number	Price Each	Collet Nut	Wrench	Stop Screw	Code
<b>DA 180 DA180 Collet Series-.031 - 0.750 (.800mm - 19mm)</b>										
3.00	1.70	4.04	-	Domestic	C50-18DA300-A	\$148.75	CN-180	WR-180	13/16-LH	B
3.38	1.44	3.30	40	Parlec	C50-18DA338-P	\$129.50	CN-180-P	WR-180-P	BS-18	B
6.00	1.70	4.04	-	Domestic	C50-18DA600-A	\$160.30	CN-180	WR-180	13/16-LH	B
6.15	1.44	6.00	40	Parlec	C50-18DA615-P	\$131.60	CN-180-P	WR-180-P	BS-18	B
8.00	1.44	5.86	40	Parlec	C50-18DA800-P	\$156.10	CN-180-P	WR-180-P	BS-18	B

## TAP HOLDERS

Tension / Compression and Synchronous Tapping. For use with Bilz Style Adapters

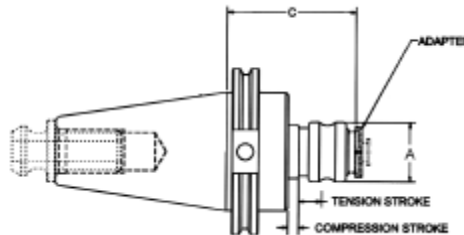

Bilz Style Adapters are located on page 169.

C Proj.	Comp.	Tension	Adapter Size	Capacity	A Dia.	Vendor	Part Number	Price Each	With Coolant Hole	Code
3.150	0.250	0.560	1	#0 - 9/16" Hand, 1/16" & 1/8" NPT	1.390	PARLEC	C50-10TA315-P	\$241.20	C50-10TA3C	B
3.150	Rigid	Rigid			1.390	PARLEC	C50-10TR315-P	\$208.25	C50-10TR3C	B
3.440	Rigid	Rigid			1.250	USST	C50-10FS344-U	\$187.50	-	D
3.520	0.300	0.300			1.417	USST	C50-10TA352-U	\$225.00	-	D
4.000	0.380	0.880			1.250	COLLIS	C50-10TA400-C	\$208.74	-	C
3.050	0.250	0.560	2	5/16" - 7/8" Hand, 1/4" & 1/2" NPT	2.180	PARLEC	C50-20TA305-P	\$283.50	C50-20TA4C	B
3.050	Rigid	Rigid			2.180	PARLEC	C50-20TR305-P	\$249.05	C50-20TR4C	B
3.540	Rigid	Rigid			1.960	USST	C50-20FS354-U	\$225.00	-	D
3.930	0.492	0.492			2.080	USST	C50-20TA393-U	\$300.00	-	D
4.890	0.380	0.880			1.960	COLLIS	C50-20TA489-C	\$238.56	-	C
4.720	Rigid	Rigid	3	13/16" - 1 3/8" Hand, 3/4" - 1" NPT	2.830	USST	C50-30FS472-U	\$220.00	-	D
5.650	0.250	0.560			3.260	PARLEC	C50-30TA565-P	\$342.90	C50-30TA5C	B
5.650	Rigid	Rigid			3.260	PARLEC	C50-30FS565-P	\$323.85	C50-30FS5C	B
5.780	0.787	0.787			3.070	USST	C50-30TA578-U	\$400.00	-	D
6.190	0.380	0.880			2.830	COLLIS	C50-30TA619-C	\$294.42	-	C
6.290	0.885	0.885	4	-	3.780	USST	C50-40TA629-U	\$930.00	-	D

Call Us Or Visit Our Website For Our Complete Selection!

# CAT-50 TOOL HOLDERS

## SHELL MILL HOLDERS

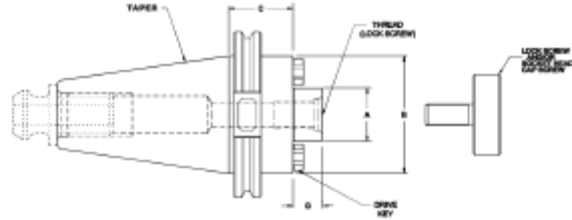

Shell Mills are located on pages 350-353.



A Pilot Dia	B Dia	C Proj.	G	Shell Mill Dia	Vendor	Part Number	Price Each	Drive Key	Lock Screw	Thread	Arbor Screw	Code
3/4" 0.750	2.750	1.500	0.68	-	DOMESTIC	C50-75SM150-A	<b>\$102.90</b>	BDK-312	B5002	3/8" - 24	-	B
	1.940	1.500	-	-	COLLIS	C50-75SM150-C	<b>\$111.79</b>	64751	-	3/8" - 24	64831	C
	1.750	1.500	0.68	-	USST	C50-75SM150-U	<b>\$99.99</b>	75KY	75LS	3/8" - 24	-	D
	1.750	1.500	0.68	-	PARLEC	C50-75SM150-P	<b>\$106.40</b>	75KY	-	3/8" - 24	028-192	B
1" 1.000	2.190	2.000	0.68	-	DOMESTIC	C50-10SM200-A	<b>\$100.80</b>	BDK-375	B5003	1/2" - 20	-	B
	2.750	2.000	-	-	COLLIS	C50-10SM200-C	<b>\$111.79</b>	64752	-	1/2" - 20	64832	C
	2.250	2.000	0.68	-	USST	C50-10SM200-U	<b>\$99.99</b>	10KY	10LS	1/2" - 20	-	D
	2.250	2.000	0.68	-	PARLEC	C50-10SM200-P	<b>\$104.30</b>	10KY	10LS	1/2" - 20	028-188	B
1 1/4" 1.250	1.500	1.500	0.68	-	DOMESTIC	C50-12SM150-A	<b>\$112.00</b>	BDK-500	B5004	5/8" - 18	-	B
	2.750	1.500	-	-	COLLIS	C50-12SM150-C	<b>\$111.79</b>	64753	-	5/8" - 18	64833	C
	1.500	1.500	0.68	-	USST	C50-12SM150-U	<b>\$99.99</b>	12KY	12LS	5/8" - 18	-	D
	1.500	1.500	0.68	-	PARLEC	C50-12SM150-P	<b>\$115.50</b>	12KY	12LS	5/8" - 18	028-193	B
1 1/2" 1.500	3.810	2.400	0.93	-	DOMESTIC	C50-15SM240-A	<b>\$105.70</b>	BDK-625	B5005	3/4" - 16	-	B
	3.940	2.400	-	-	COLLIS	C50-15SM240-C	<b>\$119.28</b>	64754	-	3/4" - 16	64834	C
	3.750	2.400	0.94	-	USST	C50-15SM240-U	<b>\$99.99</b>	15KY	15LS	3/4" - 16	-	D
	3.750	2.400	0.94	-	PARLEC	C50-15SM240-P	<b>\$109.20</b>	15KY	15LS	3/4" - 16	-	B

## JACOBS TAPER HOLDERS

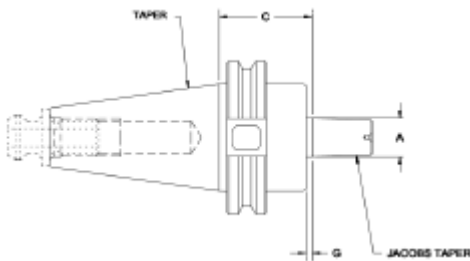

Jacobs Taper	C Proj.	A Dia.	G	Taper Length	Vendor	Part Number	Price Each	Code
2	1.375	0.559	-	-	DOMESTIC	C50-02JT137-A	<b>\$81.90</b>	B
	1.500	0.559	0.12	-	PARLEC	C50-02JT150-P	<b>\$84.70</b>	B
	1.562	-	-	-	COLLIS	C50-02JT156-C	<b>\$85.68</b>	C
3	1.375	0.811	-	-	DOMESTIC	C50-03JT137-A	<b>\$77.70</b>	B
	1.500	0.811	0.12	-	PARLEC	C50-03JT150-P	<b>\$80.50</b>	B
	1.594	-	-	-	COLLIS	C50-03JT159-C	<b>\$85.68</b>	C
4	1.375	1.120	-	-	DOMESTIC	C50-04JT137-A	<b>\$81.90</b>	B
	1.500	1.124	0.12	-	PARLEC	C50-04JT150-P	<b>\$84.70</b>	B
	1.594	-	-	-	COLLIS	C50-04JT159-C	<b>\$85.68</b>	C
6	1.375	0.676	-	-	DOMESTIC	C50-06JT137-A	<b>\$81.90</b>	B
	1.500	0.676	0.12	-	PARLEC	C50-06JT150-P	<b>\$84.70</b>	B
	1.594	-	-	-	COLLIS	C50-06JT159-C	<b>\$85.68</b>	C
33	1.375	0.624	-	-	DOMESTIC	C50-33JT137-A	<b>\$81.90</b>	B
	1.500	0.624	0.12	-	PARLEC	C50-33JT150-P	<b>\$84.70</b>	B
	1.594	-	-	-	COLLIS	C50-33JT159-C	<b>\$85.68</b>	C

## TOOL FIXTURES



- FEATURES:**
- Holds your CAT-40/50 Tool Holders and keeps them from moving while being tightened.
  - Universal Handle makes it easy to use in any position.

**D**

Taper	Part Number	Price Each
CAT 40	TF-4001	<b>\$95.00</b>
CAT 50	TF-5001	<b>\$175.00</b>

## STURDY PLASTIC HOLDING TRAYS

For CAT or BT Taper Toolholders



- FEATURES:**
- Can be used with CAT or BT Holders.
  - Available for 30 or 40 taper Tool Holders.
  - An inexpensive way to organize your tool holders.

**B**

Taper Size	No. of Holes	Part Number	Price Each
CAT/BT30	10	TRAY30-10	<b>\$24.50</b>
CAT/BT40	10	TRAY40-10	<b>\$24.50</b>

**Call Us Today For All Of Your Machine Tool Needs!**

# CAT-50 TOOL HOLDERS

## MORSE TAPER HOLDERS

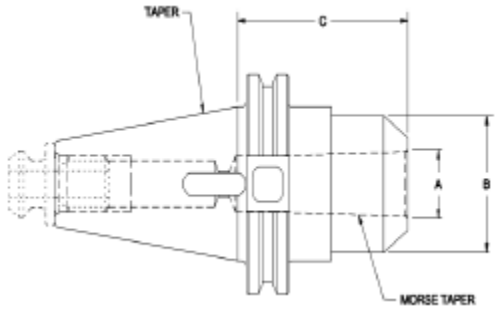

Morse Taper	C Proj.	A Dia.	B Face Dia.	Vendor	Part Number	Price Each	Code
1	1.50	-	1.00	COLLIS	C50-01MT150-C	\$93.17	C
	1.50	0.475	2.75	PARLEC	C50-01MT150-P	\$112.00	B
2	2.00	-	1.25	COLLIS	C50-02MT200-C	\$93.17	C
	2.00	0.700	1.25	DOMESTIC	C50-02MT200-A	\$95.90	B
	1.50	0.700	2.75	PARLEC	C50-02MT150-P	\$97.30	B
3	2.50	-	1.62	COLLIS	C50-03MT250-C	\$93.17	C
	2.50	0.938	1.62	DOMESTIC	C50-03MT250-A	\$95.90	B
	2.31	0.938	2.25	PARLEC	C50-03MT231-P	\$97.30	B
4	3.37	-	2.00	COLLIS	C50-04MT337-C	\$93.17	C
	3.38	1.231	2.00	DOMESTIC	C50-04MT338-A	\$95.90	B
	3.18	1.231	2.25	PARLEC	C50-04MT318-P	\$97.30	B
5	3.75	-	2.75	COLLIS	C50-05MT375-C	\$108.08	C
	3.75	1.748	2.75	DOMESTIC	C50-05MT375-A	\$114.10	B
	4.75	1.748	2.75	PARLEC	C50-05MT475-P	\$117.60	B

## AF COLLET CHUCKS CAT 40 & CAT 50

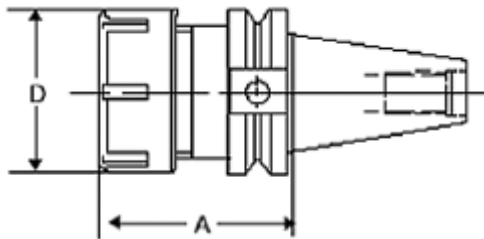

Taper	Collet Series	A (in.)	D (in.)	Part Number	Price Each
BT 40	AF 75	2.72	1.94	B40-75AF256-A	\$149.00
	AF 100	3.00	2.48	B40-10AF315-A	\$151.00
CAT 40	AF 75	2.72	1.94	C40-75AF3-U	\$98.33
	AF 100	3.00	2.48	C40-10AF3-U	\$103.55
CAT 50	AF 100	3.00	2.48	C50-10AF3-U	\$137.75
	AF 100	6.00	2.48	C50-10AF6-U	\$181.45

## COLLET EXTENSIONS FOR AF SERIES COLLETS

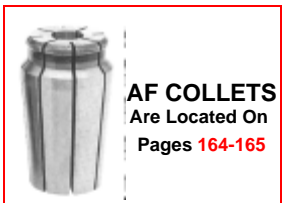
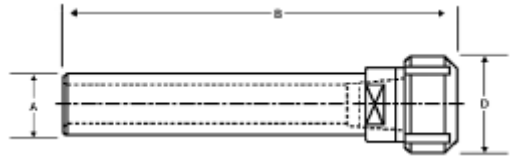

**AF COLLETS**  
Are Located On  
Pages 164-165

Collet Type	A (in.)	B (in.)	D (in.)	Part Number	Price Each	Collet Nut	Price Each	Wrench	Price Each
RDF/AF 25	0.50	7.00	0.73	ST-05-25AF7	\$80.75	CN-AF25	\$16.00	-	-
RDF/AF 38	0.75	7.00	1.08	ST-75-38AF7	\$80.75	CN-AF38	\$18.00	-	-
RDF/AF 50	0.75	7.50	1.34	ST-75-50AF7	\$90.25	CN-AF50	\$19.00	WR-AF50	\$18.00
RDF/AF 75	1.00	7.00	1.96	ST-10-75AF7	\$104.50	CN-AF75	\$41.00	WR-AF75	\$21.00

## TOOL PRESETTERS

### Why Use A Presetter?

A Tool Measuring Machine (TMM) used for off-line tool qualification allows you to determine a tool's precise measurements without tying up valuable machine time touching off or inputting data. When your machine is not cutting chips, it is not making money. A presetter saves time and eliminates the need for trial cuts and wasted material. Keep down-time to a minimum with a **PARLEC** tool presetter!

We offer the complete line of **PARLEC** Presetters!  
Please Call For More Information!

**Set-Up and Technical Assistance Available!**



Parsetter Series  
950 TMM

**Parsetter 950 TMM Series** presetters are the most rugged, dependable machines in their class. Perfectly suited for shop floor use, these machines can provide basic presetting and exceptional repeatability under almost any condition. A 100mm Optical Projector is standard on all Series 950 machines.

Parsetter 950 TMM

**Call For More Information!**

**Call Us Or Visit Our Website For Our Complete Selection!**